

NOTICE!!

These documents have been scanned!

Do not place un-scanned documents beneath this notice!

Do not remove this notice from this file!

GPO Jacket No. 560-102
Print Order 61540
Rise Business Services, LLC
Job=AZ15 5/1/2019



Box Number= AZ15013



Claim Begin-End: AMC440407-AMC440416

1 Initial Receipt



AZ15013-26

AMC440098-AMC440515

United States Department of the Interior
Bureau of Land Management
 DIV OF LANDS, MINRLS & ENERGY
 ONE N CENTRAL AVE
 PHOENIX, AZ 85004 -4427
 Phone: 602-417-9200

Receipt

No: 3715646

Transaction #: 3820664	
Date of Transaction: 12/05/2016	
CUSTOMER:	
KLUMP RANCHES LLC PO BOX 448 BOWIE,AZ 85605-0448 US	

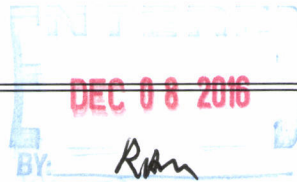

LINE #	QTY	DESCRIPTION	REMARKS	UNIT PRICE	TOTAL
1	10.00	LOCATABLE MINERALS / MINING CLAIMS-NEW,UNADJUD, ONE OR MORE AUTH NOS / NEW MINING CLAIMS LOCATION FEE CASES: AMC440407/\$37.00, AMC440408/\$37.00, AMC440409/\$37.00, AMC440410/\$37.00, AMC440411/\$37.00, AMC440412/\$37.00, AMC440413/\$37.00, AMC440414/\$37.00, AMC440415/\$37.00, AMC440416/\$37.00		- n/a -	370.00
2	10.00	LOCATABLE MINERALS / MINING CLAIMS-NEW,UNADJUD, ONE OR MORE AUTH NOS / NEW MINING CLAIM PROCESSING FEE CASES: AMC440407/\$20.00, AMC440408/\$20.00, AMC440409/\$20.00, AMC440410/\$20.00, AMC440411/\$20.00, AMC440412/\$20.00, AMC440413/\$20.00, AMC440414/\$20.00, AMC440415/\$20.00, AMC440416/\$20.00		- n/a -	200.00
3	10.00	LOCATABLE MINERALS / MINING CLAIMS-NEW,UNADJUD, ONE OR MORE AUTH NOS / NEW MINING CLAIMS MAINTENANCE FEE CASES: AMC440407/\$155.00, AMC440408/\$155.00, AMC440409/\$155.00, AMC440410/\$155.00, AMC440411/\$155.00, AMC440412/\$155.00, AMC440413/\$155.00, AMC440414/\$155.00, AMC440415/\$155.00, AMC440416/\$155.00		- n/a -	1550.00
TOTAL:					\$2,120.00

PAYMENT INFORMATION			
1	AMOUNT:	2120.00	POSTMARKED: 11/30/2016
	TYPE:	CHECK	RECEIVED: 12/02/2016

CHECK NO:	1991
NAME:	KLUMP RANCHES, LLC PO BOX 448 BOWIE AZ 85605-0448 US

REMARKS

This receipt was generated by the automated BLM Collections and Billing System and is a paper representation of a portion of the official electronic record contained therein.

NOTICE!!

These documents have been scanned!

Do not place un-scanned documents beneath this notice!

Do not remove this notice from this file!

GPO Jacket No. 560-102
Print Order 61540
Rise Business Services, LLC
Job=AZ15 5/1/2019



Box Number= AZ15013



Claim Begin-End: AMC440407-AMC440416

2 Correspondence



AZ15013-26

AMC440098-AMC440515

**NO
DOCUMENTS
FOUND**

NO DOCUMENTS FOUND
NO DOCUMENTS FOUND

NOTICE!!

These documents have been scanned!

Do not place un-scanned documents beneath this notice!

Do not remove this notice from this file!

GPO Jacket No. 560-102
Print Order 61540
Rise Business Services, LLC
Job=AZ15 5/1/2019



Box Number= AZ15013



Claim Begin-End: AMC440407-AMC440416

3 Transfers



AZ15013-26

AMC440098-AMC440515

**NO
DOCUMENTS
FOUND**

NO DOCUMENTS FOUND
NO DOCUMENTS FOUND

NOTICE!!

These documents have been scanned!

Do not place un-scanned documents beneath this notice!

Do not remove this notice from this file!

GPO Jacket No. 560-102
Print Order 61540
Rise Business Services, LLC
Job=AZ15 5/1/2019



Box Number= AZ15013



Claim Begin-End: AMC440407-AMC440416

4 Annual Filings



AZ15013-26

AMC440098-AMC440515

UNITED STATES
DEPARTMENT OF THE INTERIOR
BUREAU OF LAND MANAGEMENT

479
[Handwritten Signature]

440407

MAINTENANCE FEE WAIVER CERTIFICATION

FORM APPROVED
OMB NO. 1004-0114
Expires: January 31, 2020

SEE INSTRUCTIONS ON PAGE 2

- This small miner waiver is filed for the assessment year beginning on September 1, 2019 and ending on September 1, 2020
- The undersigned and all related parties owned ten or fewer mining claims, mill, or tunnel sites located and maintained on Federal lands in the United States of America on September 1, 2019.
- The undersigned have performed the assessment work required by law for each mining claim listed prior to filing this waiver and understand that by filing this for the undersigned must file an affidavit of assessment work with the Bureau of Land Management (BLM) by the December 30th following the filing of this waiver.
- The undersigned understand that if the assessment work obligation has not yet come due under 30 U.S.C. 28 (for those claims in their first assessment year only), a notice of intent to hold reciting this condition must be recorded by the December 30th following the filing of this waiver.
- The undersigned understand that mill and tunnel sites may also be listed on this waiver and be waived from payment of the maintenance fee, and that a notice of intent to hold for these sites is required to be filed with the BLM by the December 30th following the filing of this waiver.
- The undersigned understand and acknowledge that pursuant to 43 U.S.C. 1212 and 18 U.S.C. 1001, the filing or recording of a false, fictitious, or fraudulent document with the BLM may result in a fine of up to \$250,000, a prison term not to exceed five years, or both.
- The mining claims, mill or tunnel sites for which this waiver from payment of the maintenance fees is requested are:

CLAIM OR SITE NAME	BLM RECORDATION SERIAL NUMBER
1. Park #1 ✓	440407
2. Park #2	440408
3. Park #3	440409
4. Park #4	440410
5. Park #5	440411
6. Park #6	440412
7. Park #7	440413
8. Park #8	440414
9. Park #9	440415
10. Park #10	440416

RECEIVED
 BLM AT STATE OFFICE
 2019 AUG 21 P 2:03
 PHOENIX, ARIZONA

The owner(s) (claimants) of the above mining claims and sites are:

Klump Ranches LLC
(Owner's Name - Please Print)

[Handwritten Signature]
(Owner's Signature)

P.O. Box 448
(Owner's Mailing Address)

Bowie AZ 85605
(City) (State) (Zip Code)

(Owner's Name - Please Print)

(Owner's Signature)

(Owner's Mailing Address)

(City) (State) (Zip Code)

(Owner's Name - Please Print)

(Owner's Signature)

(Owner's Mailing Address)

(City) (State) (Zip Code)

(Owner's Name - Please Print)

(Owner's Signature)

(Owner's Mailing Address)

(City) (State) (Zip Code)

UNITED STATES
DEPARTMENT OF THE INTERIOR
BUREAU OF LAND MANAGEMENT

426

440407

MAINTENANCE FEE WAIVER CERTIFICATION

FORM APPROVED
OMB NO. 1004-0114
Expires: January 31, 2020

[Handwritten signature]

SEE INSTRUCTIONS ON PAGE 2

- This small miner waiver is filed for the assessment year beginning on September 1, 18 and ending on September 1, 19.
- The undersigned and all related parties owned ten or fewer mining claims, mill, or tunnel sites located and maintained on Federal lands in the United States of America on September 1, 18.
- The undersigned have performed the assessment work required by law for each mining claim listed prior to filing this waiver and understand that by filing this for the undersigned must file an affidavit of assessment work with the Bureau of Land Management (BLM) by the December 30th following the filing of this waiver.
- The undersigned understand that if the assessment work obligation has not yet come due under 30 U.S.C. 28 (for those claims in their first assessment year only), a notice of intent to hold reciting this condition must be recorded by the December 30th following the filing of this waiver.
- The undersigned understand that mill and tunnel sites may also be listed on this waiver and be waived from payment of the maintenance fee, and that a notice of intent to hold for these sites is required to be filed with the BLM by the December 30th following the filing of this waiver.
- The undersigned understand and acknowledge that pursuant to 43 U.S.C. 1212 and 18 U.S.C. 1001, the filing or recording of a false, fictitious, or fraudulent document with the BLM may result in a fine of up to \$250,000, a prison term not to exceed five years, or both.
- The mining claims, mill or tunnel sites for which this waiver from payment of the maintenance fees is requested are:

CLAIM OR SITE NAME	BLM RECORDATION SERIAL NUMBER
1. Park # 1	440407 (913)
2. Park # 2	440408
3. Park # 3	440409
4. Park # 4	440410
5. Park # 5	440411
6. Park # 6	440412
7. Park # 7	440413
8. Park # 8	440414
9. Park # 9	440415
10. Park # 10	440416

RECEIVED
 BLM AZ STATE OFFICE
 2018 AUG 23 P 2:46

The owner(s) (claimants) of the above mining claims and sites are:

100%

Klump Ranches LLC
(Owner's Name - Please Print)

[Handwritten Signature]
(Owner's Signature)

P.O. Box 448
(Owner's Mailing Address)

Bowie AZ 85605
(City) (State) (Zip Code)

(Owner's Name - Please Print)

(Owner's Signature)

(Owner's Mailing Address)

(City) (State) (Zip Code)

(Owner's Name - Please Print)

(Owner's Signature)

(Owner's Mailing Address)

(City) (State) (Zip Code)

AC 483
ENTERED SEP 13 2018

AC 247 WHO SIGNED For the LLC?

9/20/18 = AC 247 Removed per Amy D.
(Owner's Name - Please Print)

[Handwritten Signature]
(Owner's Signature)

(Owner's Mailing Address)

(City) (State) (Zip Code)

(Continued on page 2)

nwy/ps

4245147

Klump Ranches LLC
P.O. Box 448
Bowie, AZ 85605

Check here is this is a change of address.

Telephone: 520-507-5118

E-mail address: _____

AFFIDAVIT OF PERFORMANCE OF ANNUAL WORK

1. State of Arizona, County of Cochise ss:

2. I (Name) Matt Klump

3. Reside at (Address) 6401 E. Page Ranch Rd

City Bowie County Cochise

RECEIVED
BLM AZ STATE OFFICE
2018 AUG 23 P 2:46
PHOENIX, ARIZONA
BLM
Date
Stamp

State AZ Zip 85605 being duly sworn, depose and say that I am a citizen of the United States, more than eighteen years of age, and that all of the facts set forth in this affidavit, subject to the provisions and penalties of 18 U.S.C. 1001 pertaining to the filing of false, fictitious, or fraudulent statements with the United States, are true and correct according to the best of my knowledge, information and belief.

4. Owner's name and address (if not shown in items 1-3 above): _____

5. That I am personally acquainted with the mining claim(s). The work and improvements were made by and at the expense of the owner(s) of said claim(s). Said contiguous group of claims, listed on this document, are situated in the

Tevis (optional) Mining District; Cochise County, Arizona.

Line No.	AMC NUMBER	CLAIM/SITE NAME	COUNTY RECORDER DATA (if available)	TWP	RNG	SEC
1	440407	Park # 1		14S	27E	7
2	440408	Park # 2		14S	27E	7
3	440409	Park # 3		14S	27E	7
4	440410	Park # 4		14S	27E	7
5	440411	Park # 5		14S	27E	7
6	440412	Park # 6		14S	27E	7

Form: MCF108
Revised Jan. 2006
Page 1 of 2

ENTERED
AUG 29 2018
BY: RAM

RECEIVED
BLM AZ STATE OFFICE
2018 AUG 23 P 2:44
PHOENIX, ARIZONA
BLM
Date
Stamp

7	440413	Park #7		145	27E	7
8	440414	Park #8		145	27E	7
9	440415	Park #9		145	27E	8
10	440416	Park #10		145	27E	8

6. That between the dates starting at 12 o'clock noon on September 1, 20 17 and ending at 12 o'clock noon on September 1, 20 18 at least \$ 1000 dollars worth of work and improvements were done and performed upon said claim(s) or upon one or more of a contiguous group of claims for the benefit of all, wholly or partly outside of a contiguous group of claims for the benefit of all, not including the location work.

7. That the following persons were employed to perform the work and improvements described herein: Math Klump

8. That the work and improvements performed were: Water-line, Cabin, Tunnel, Monument Work Road Work

9. Dated: 8/20/18 Signature: [Signature]

SUBSCRIBED AND SWORN TO before me, a Notary Public, this 20 day of Aug, 20 18

By: Angela Diaz
Notary Public Angela Diaz

My Commission Expires 1-16-2019

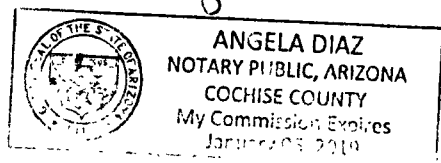

Bureau of Land Management
Arizona State Office
www.az.blm.gov

No. of Claims: _____ x \$10 = _____
 Check No.: _____ Init. _____
 Receipt No.: 4245147
 For BLM Use Only

Klump Ranches LLC
PO Box 448
Bowie AZ 85605

PHOENIX AZ 852

21 AUG 2019 PM 10 1



BLM

1 N Central Av
Phoenix AZ 85004

PHOENIX, ARIZONA

2018 AUG 23 P 2:46

RECEIVED
BLM AZ STATE OFFICE

85004-442700



United States Department of the Interior
Bureau of Land Management
 DIV OF LANDS, MINRLS & ENERGY
 ONE N CENTRAL AVE
 PHOENIX, AZ 85004 -4427
 Phone: 602-417-9200

Receipt

No: 4245147

Transaction #: 4360599	
Date of Transaction: 08/27/2018	
CUSTOMER:	
KLUMP RANCHES LLC PO BOX 448 BOWIE,AZ 85605-0448 US	

LINE #	QTY	DESCRIPTION	REMARKS	UNIT PRICE	TOTAL
1	1.00	LOCATABLE MINERALS / MINING CLAIMS- NOT NEW-UNADJUD,ONE AUTH NO. ONLY / MINING CLAIM MONEY RECEIVED CASES: AMC440407/\$100.00	POL 2018/10 WAV	- n/a -	100.00
TOTAL:					\$100.00

PAYMENT INFORMATION			
1	AMOUNT:	100.00	POSTMARKED: N/A
	TYPE:	CHECK	RECEIVED: 08/23/2018
	CHECK NO:	2389	
	NAME:	KLUMP RANCHES LLC PO BOX 448 BOWIE AZ 85605-0448 US	

REMARKS

This receipt was generated by the automated BLM Collections and Billing System and is a paper representation of a portion of the official electronic record contained therein.

215

[Handwritten signature]

MAINTENANCE FEE WAIVER CERTIFICATION

FORM APPROVED
OMB NO. 1004-0114
Expires: October 31, 2016

Amc 440407

SEE INSTRUCTIONS ON PAGE 2

- This small miner waiver is filed for the assessment year beginning on September 1, 17 and ending on September 1, 18.
- The undersigned and all related parties owned ten or fewer mining claims, mill, or tunnel sites located and maintained on Federal lands in the United States of America on September 1, 17.
- The undersigned have performed the assessment work required by law for each mining claim listed prior to filing this waiver and understand that by filing this form, the undersigned must file an affidavit of assessment work with the Bureau of Land Management (BLM) by the December 30th following the filing of this waiver.
- The undersigned understand that if the assessment work obligation has not yet come due under 30 U.S.C. 28 (for those claims in their first assessment year only), a notice of intent to hold reciting this condition must be recorded by the December 30th following the filing of this waiver.
- The undersigned understand that mill and tunnel sites may also be listed on this waiver and be waived from payment of the maintenance fee, and that a notice of intent to hold for these sites is required to be filed with the BLM by the December 30th following the filing of this waiver.
- The undersigned understand and acknowledge that pursuant to 43 U.S.C. 1212 and 18 U.S.C. 1001, the filing or recording of a false, fictitious, or fraudulent document with the BLM may result in a fine of up to \$250,000, a prison term not to exceed five years, or both.
- The mining claims, mill or tunnel sites for which this waiver from payment of the maintenance fees is requested are:

CLAIM OR SITE NAME	BLM RECORDATION SERIAL NUMBER
1. Park # 1	440407
2. Park # 2	440408
3. Park # 3	440409
4. Park # 4	440410
5. Park # 5	440411
6. Park # 6	440412
7. Park # 7	440413
8. Park # 8	440414
9. Park # 9	440415
10. Park # 10	440416

The owner(s) (claimants) of the above mining claims and sites are:

Klump Ranches LLC
(Owner's Name - Please Print)

P.O. Box 448
(Owner's Mailing Address)

[Handwritten Signature]
(Owner's Signature)

Bowie AZ 85605
(City) (State) (Zip Code)

(Owner's Name - Please Print)

(Owner's Mailing Address)

(Owner's Signature)

(City) (State) (Zip Code)

AC483
ENTERED SEP 06 2017
PB

2017 SEP 17 10:33:08
BLM RECEIVED
PHOENIX, ARIZONA

(Owner's Name - Please Print)

(Owner's Mailing Address)

(Owner's Signature)

(City) (State) (Zip Code)

(Owner's Name - Please Print)

(Owner's Mailing Address)

(Owner's Signature)

(City) (State) (Zip Code)

(Continued on page 2)

NW CHECK
10 CT

UNITED STATES DEPARTMENT OF THE INTERIOR
BUREAU OF LAND MANAGEMENT

MC NATIONWIDE CLAIMANT LISTING
September 14, 2017

Cust	AZ CLAIMANT	National Total
KLUMP RANCHES LLC PO BOX 448 BOWIE, AZ 85605-0448	10	10

When Recorded Return Document to:

klump ranches LLC
P.O. Box 448
Bowie, AZ 85605

2017-07-25 09:18
Page 1 of 1
Recorded at Klump Ranches, LLC
David G. Propp - Recorder
Cochise County, AZ
07-25-2017 10:47 AM Recording Fee \$15.00

Check here if this is a change of address.

Telephone: 520-507-5118

E-mail address: _____

AMC440407

AFFIDAVIT OF PERFORMANCE OF ANNUAL WORK

1. State of Arizona, County of Cochise ss.
2. I (Name) Matt Klump
3. Reside at (Address) 6401 E. Page Ranch Rd

City Bowie County Cochise

BLM
Date
Stamp
2017 AUG -7 10 30 AM

State AZ Zip 85605 being duly sworn, depose and say that I am a citizen of the United States, more than eighteen years of age, and that all of the facts set forth in this affidavit, subject to the provisions and penalties of 18 U.S.C. 1001 pertaining to the filing of false, fictitious, or fraudulent statements with the United States, are true and correct according to the best of my knowledge, information and belief.

4. Owner's name and address (if not shown in items 1-3 above). _____

5. That I am personally acquainted with the mining claim(s). The work and improvements were made by and at the expense of the owner(s) of said claim(s). Said contiguous group of claims, listed on this document, are situated in the

Tevis (optional) Mining District, Cochise County, Arizona.

Line No.	ADIC NUMBER	CLAIM/SITE NAME	COUNTY RECORDER DATA (if available)	TWP	RNG	SEC
1	440407	Park # 1		14S	27E	7
2	440408	Park # 2		14S	27E	7
3	440409	Park # 3		14S	27E	7
4	440410	Park # 4		14S	27E	7
5	440411	Park # 5		14S	27E	7
6	440412	Park # 6		14S	27E	7

Form: MCF103
Revised Jan. 2006
Page 1 of 2

ENTERED
AUG 22 2017
BY: [Signature]

FIRM
Date
Range

2017
8-1-17
8-1-17

10	440413	Park #7	145	27E	87
3	440414	Park #8	145	27E	7
3	440415	Park #9	145	27E	8
10	440416	Park #10	145	27E	8

6. That between the dates starting at 12 o'clock noon on September 1, 20 16 and ending at 12 o'clock noon on September 1, 20 17 at least \$ 1,000 dollars worth of work and improvements were done and performed upon said claim(s) or upon one or more of a contiguous group of claims for the benefit of all, wholly or partly outside of a contiguous group of claims for the benefit of all, not including the location work.

7. That the following persons were employed to perform the work and improvements described herein: Matt Klump

8. That the work and improvements performed were: Water line, Cabin, Tunnel, and Movement West Road work

9. Dated: 8/2/17 Signature: [Signature]

SUBSCRIBED AND SWORN TO before me, a Notary Public, this 2 day of August 20 17

By: Angela Diaz
Notary Public Angela Diaz
My Commission Expires 1-6-19

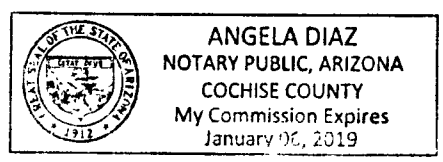

Bureau of Land Management
Maricopa State Office
Phoenix, Arizona

No. of Claims: 10 x \$10 = 100
Check No: 2136 Int: FILE
Receipt No: 3926680
The BLM Fee Only

Form 1-0312
Revised Jan. 2016
Page 2 of 2

United States Department of the Interior
Bureau of Land Management
 DIV OF LANDS, MINRLS & ENERGY
 ONE N CENTRAL AVE
 PHOENIX, AZ 85004 -4427
 Phone: 602-417-9200

Receipt

No: 3926680

Transaction #: 4036223	
Date of Transaction: 08/08/2017	
CUSTOMER:	
KLUMP RANCHES LLC PO BOX 448 BOWIE, AZ 85605-0448 US	

LINE #	QTY	DESCRIPTION	REMARKS	UNIT PRICE	TOTAL
1	1.00	LOCATABLE MINERALS / MINING CLAIMS- NOT NEW-UNADJUD, ONE AUTH NO. ONLY / MINING CLAIM MONEY RECEIVED CASES: AMC440407/\$100.00	POL 2017/10 WAV	- n/a -	100.00
TOTAL:					\$100.00

PAYMENT INFORMATION					
1	AMOUNT:	100.00	POSTMARKED:	08/03/2017	
	TYPE:	CHECK	RECEIVED:	08/07/2017	
	CHECK NO:	2126			
	NAME:	KLUMP RANCHES LLC PO BOX 448 BOWIE AZ 85605-0448 US			

REMARKS

This receipt was generated by the automated BLM Collections and Billing System and is a paper representation of a portion of the official electronic record contained therein.

NOTICE!!

These documents have been scanned!

Do not place un-scanned documents beneath this notice!

Do not remove this notice from this file!

GPO Jacket No. 560-102
Print Order 61540
Rise Business Services, LLC
Job=AZ15 5/1/2019



Box Number= AZ15013



Claim Begin-End: AMC440407-AMC440416

5 Miscellaneous



AZ15013-26

AMC440098-AMC440515

**NO
DOCUMENTS
FOUND**

NO DOCUMENTS FOUND
NO DOCUMENTS FOUND

NOTICE!!

These documents have been scanned!

Do not place un-scanned documents beneath this notice!

Do not remove this notice from this file!

GPO Jacket No. 560-102
Print Order 61540
Rise Business Services, LLC
Job=AZ15 5/1/2019



Box Number= AZ15013



Claim Begin-End: AMC440407-AMC440416

6 Location Notices-Amendments and Supporting Documents



AZ15013-26 AMC440098-AMC440515

MINING CLAIM STATUS REPORT

Data Entered: 12/8/16 Ram

MTP Checked By: 12/8/16 Ram
GEO Checked By: 12/8/16 Ram

LEAD SERIAL NUMBER: AMC 440407 thru AMC 440416

NUMBER OF CLAIMS & TYPE:

10 LODE
____ PLACER
____ ASSOCIATION PLACER
____ MILL SITE
____ TUNNEL SITE

CHARGES:

Processing Fee @ \$20 = \$ 200.00
Location Fee @ \$37 = \$ 370.00
Maintenance Fee @ \$155 = \$ 1550.00
Add'l Maint Fee for Assoc Placer = \$ 200
SUBTOTAL \$ 2120.00
Other Fees \$ _____
Other Fees \$ _____
TOTAL \$ 2120.00

TOTAL ACREAGE: N/A Per Claim
(Placer Only)

NUMBER OF LOCATORS: 1

DOCUMENTS RECEIVED VIA: Over-the-Counter [] Mail [] **TIMELY FILED:** Yes [] No []

LEGAL DESCRIPTION: T 14S R 27E SEC 7,8
T _____ R _____ SEC _____
T _____ R _____ SEC _____
T _____ R _____ SEC _____
T _____ R _____ SEC _____

BLM [] FOREST SERVICE [] _____ SUBJ TO PL 359: Yes [] No []
WILDERNESS AREA [] _____

SPLIT ESTATE: N/A [] SX [] PX [] OTHER [] _____
SRHA [] Was proper Notice filed if located on SHRA Land? Yes [] No []

RECONVEYED MINERALS ON BLM LAND REQUIRE OPENING ORDER FROM 1944 TO 1993:

Open to Entry On _____ N/A []

COMMENTS/STATUS: VOID [] PARTIALLY VOID [] PVT MINERALS [] WITHDRAWN LANDS []
OTHER [] USED TOPO MAP FOR LLD. METES & BOUNDS NOT PROVIDED.
ON TOPO MAP CLAIMS ARE ADJACENT TO EACH OTHER. ON OTHER MAPS CLAIMS APPEAR SEPARATED. -RM

[] Claimant acknowledges that portions of the following claim(s) site(s) may be void or voidable.

Printed Name of Claimant _____ Signature of Claimant _____

*****FINAL ADJUDICATION*****

DATE 7/28/2017 INITIALS RM

AMC440407

WHEN RECORDED MAIL TO:

Klump Ranches LLC
PO Box 448
Bowie AZ 85605

THE ABOVE SPACE RESERVED FOR RECORDING INFORMATION

CAPTION HEADING

DO NOT REMOVE

THIS IS PART OF THE OFFICIAL DOCUMENT

RECEIVED
PLM AT STATE OFFICE
2016 DEC - 2 P 3:44
PHOENIX, ARIZONA

AHC440407

Notice of Mining Location

LODE CLAIM

TO ALL WHOM IT MAY CONCERN:

This Mining Claim, the name of which is the Park # 1
 Mining Claim, situate on land belonging to the United States of America, and in which there are valuable mineral deposits, was entered upon and located for the purpose of exploration and purchase by Klump Ranches LLC
PO Box 448 Bowie AZ 85605
(Locator must insert either "A Citizen of the United States," or "Who has declared his intention to become a Citizen of the United States.")
 the undersigned, on the 29th day of November, 2016

The length of this claim is 1500 feet and I claim 875 feet in a easterly direction and 625 feet in a westerly direction from the center of the discovery shaft, at which this notice is posted, lengthwise of the claim together with 300 feet in width of the surface grounds, on each side of the center of said claim. The general course of the lode deposit and premises is from the easterly to the westerly.

The claim is situated and located in the Tevis Mining District, in Cochise county, in the State of Arizona, about 3/4 mile in a westerly direction from Dos Cabezas Peaks

The surface boundaries of the claim are marked upon the ground as follows:

Beginning at MONUMENT OF STONE
 at a point in a westerly direction 625 feet from the discovery shaft (at which this notice is posted), being in the center of the westerly end line of said claim; thence 300 feet to a MONUMENT, being the SW corner of said claim; thence 1500 feet to a MONUMENT being at the SE corner of said claim; thence 300 feet to a MONUMENT at the center of the easterly end of this claim; thence 300 feet to a MONUMENT, being at the NE corner of said claim; thence 1500 feet to a MONUMENT at the NW corner of said claim; thence 300 feet to the place of beginning.

RECEIVED
 DLMA DISTRICT
 2016 DEC - 2 P M
 PHOENIX, ARIZONA
 ANCHOR 1107

Dated and posted on the ground this 29th day of November, 2016

Klump Ranches LLC

MATT KLUMP

Witness

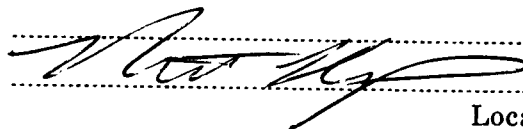

Locator(s)

Notice of Location

LODE CLAIM

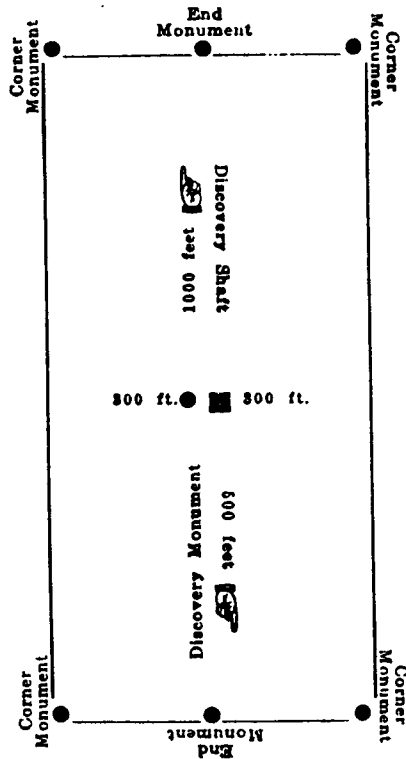

This diagram is to give locator a general idea of plan of location under the new law. The Discovery Shaft can be in the center of claim or any distance from either end desired. In the diagram it is placed 500 feet from one end, and 1000 feet from the other. Commence description of claim at a center end monument, giving its distance and direction from center of Discovery Shaft; thence bound the claim in either direction. In description be careful to state locality of claim with reference to some natural object, or permanent monument, as will identify the claim.

Dated _____, 19.....

STATE OF ARIZONA }
 County of } ss.

I hereby certify that the within instrument was filed and recorded at request of

Book.....

In Docket.....

on page.....

Witness my hand and official seal of PHOENIX, ARIZONA the day and year aforesaid.

.....
 County Recorder.

By.....
 Deputy Recorder.

RECEIVED
 PHOENIX, ARIZONA
 2015 DEC - 2 P 3 44

RECEIVED
 PHOENIX, ARIZONA
 2015 DEC - 2 P 3 44

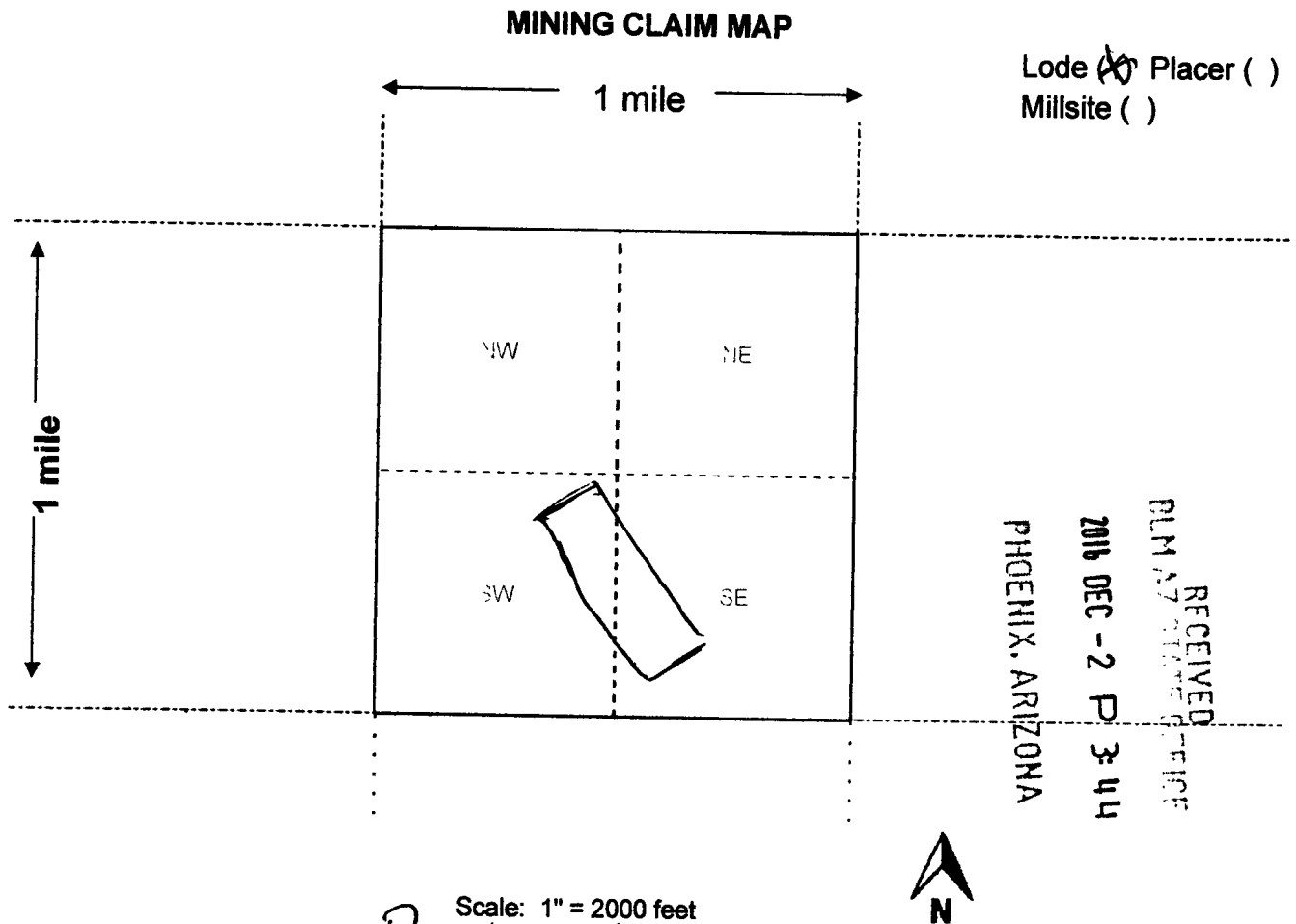

ANCI40407

Scale: 1" = 2000 feet

1. The above map depicts the Park #1 mining claim, which is located in Section (s) 7, Township 14 S, Range 27 E, Gila and Salt River Base and Meridian, _____ County, Arizona. Total claim acreage is 20

2. The type of corner and location monuments used are as follows: STONE

3. The bearings and distances in degrees and feet between claim corners and to a public land survey monument are as depicted on the map.

4. If the claim is a placer or millsite claim with exterior limits conforming to legal subdivisions of the public survey, provide a legal description of the claim _____

Form MCF100a
Revised July 2014

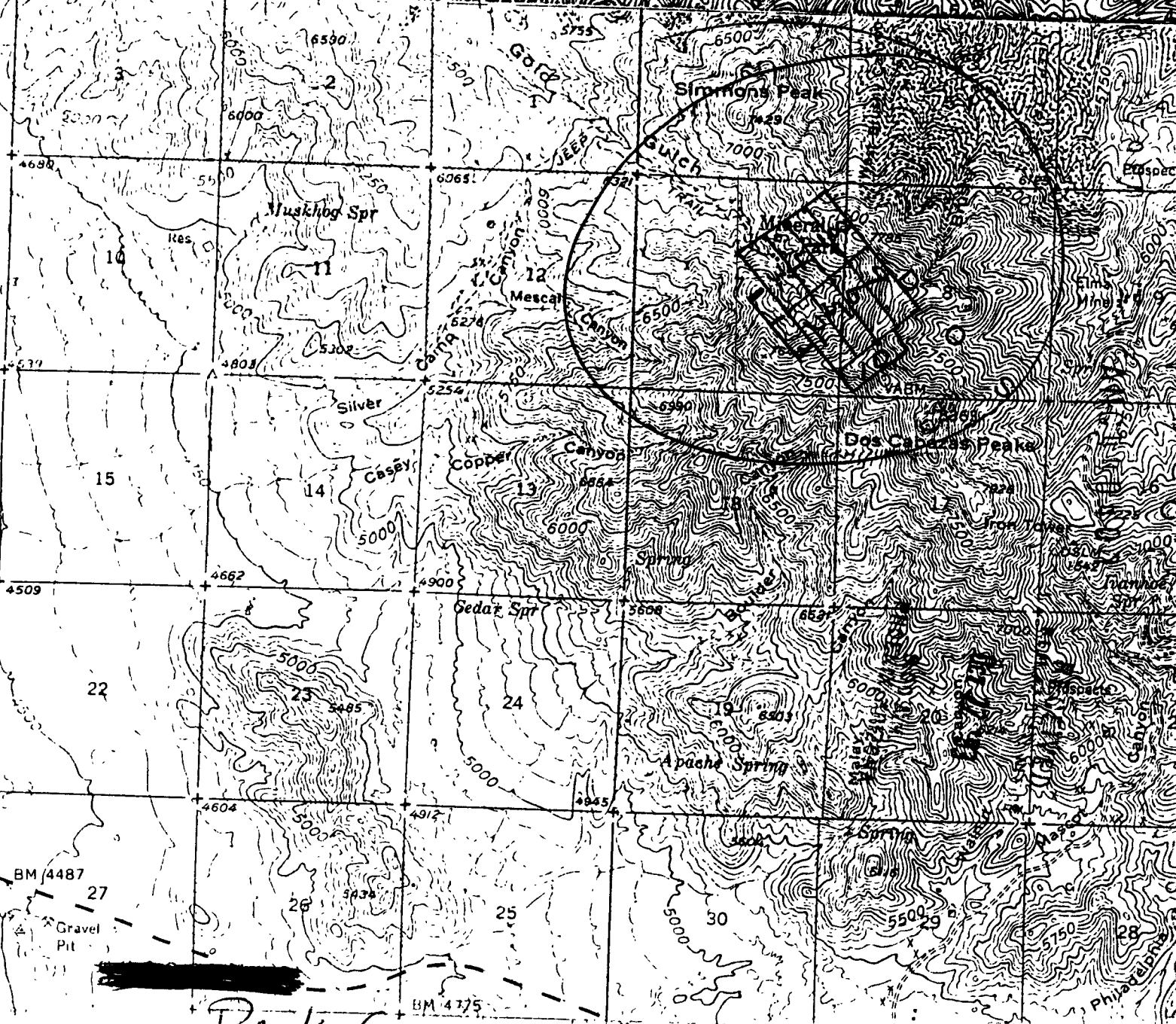
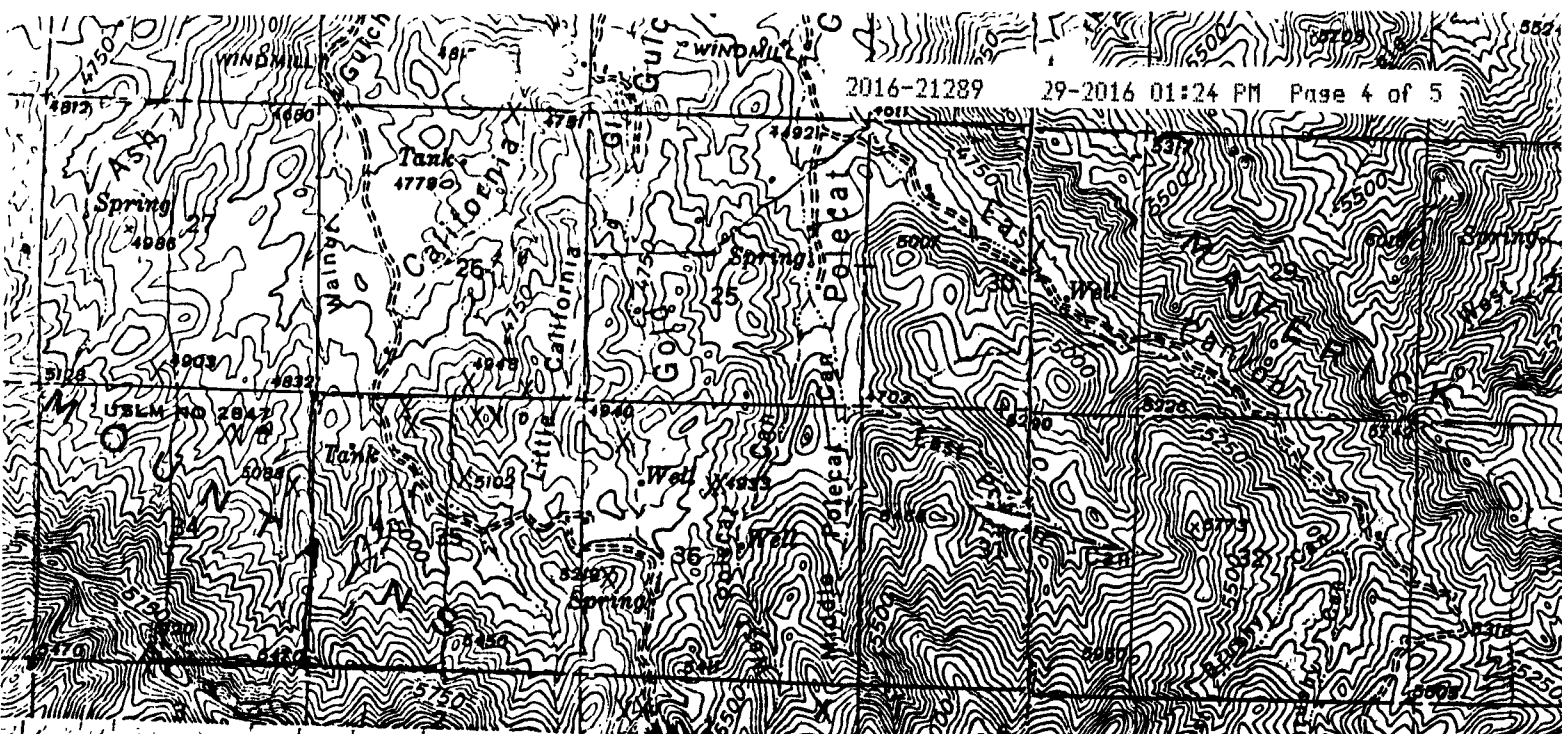

PARK GROUND # 1 Thru 10

RECEIVED
PLM
2016 DEC -2 P 3 44
PHOENIX, ARIZONA

2016-21290

Page 1 of

Requested by Klump Ranches

Christine Rhodes - Recorder

Cochise County, AZ

11-29-2016 01:24 PM Recording Fee \$9.00

WHEN RECORDED MAIL TO:

Klump Ranches LLC
PO Box 448
Bowie AZ 85605

THE ABOVE SPACE RESERVED FOR RECORDING INFORMATION

CAPTION HEADING

DO NOT REMOVE

THIS IS PART OF THE OFFICIAL DOCUMENT

RECEIVED
PLM AT STAFF OFFICE
2016 DEC -2 P 3:44
PHOENIX, ARIZONA

AMC140408

Notice of Mining Location

LODE CLAIM

TO ALL WHOM IT MAY CONCERN:

This Mining Claim, the name of which is the Park #2

Mining Claim, situate on land belonging to the United States of America, and in which there are valuable mineral deposits, was entered upon and located for the purpose of exploration and purchase by

Klump Ranches LLC
PO Box 448 Bowie AZ 85605

(Locator must insert either "A Citizen of the United States," or "Who has declared his intention to become a Citizen of the United States.")
the undersigned, on the 29th day of November, 2016

The length of this claim is 1500 feet and I claim 1375 feet in a easterly direction and 125 feet in a westerly direction from the center of the discovery shaft, at which this notice is posted, lengthwise of the claim together with 300 feet in width of the surface grounds, on each side of the center of said claim. The general course of the lode deposit and premises is from the easterly to the westerly.

The claim is situated and located in the Tevlis Mining District, in Cochise county, in the State of Arizona, about 3/4 mile in a westerly direction from DOSCABEAS PEAKS

RECEIVED
MAY 17 2016
PHOENIX, ARIZONA
DEC - 2 P 3 44

The surface boundaries of the claim are marked upon the ground as follows:
Beginning at MONUMENT OF STONE
at a point in a westerly direction 125 feet from the discovery shaft (at which this notice is posted), being in the center of the

end line of said claim; thence 300 feet to a MONUMENT, being the SW corner of said claim; thence 1500 feet to a MONUMENT being at the SE corner of said claim; thence 300 feet to a MONUMENT at the center of the easterly end of this claim; thence 300 feet to a MONUMENT, being at the NE corner of said claim; thence 1500 feet to a MONUMENT at the NW corner of said claim; thence 300 feet to the place of beginning.

Dated and posted on the ground this 29th day of November, 2016

Klump Ranches LLC
MATT KLUMP

Witness

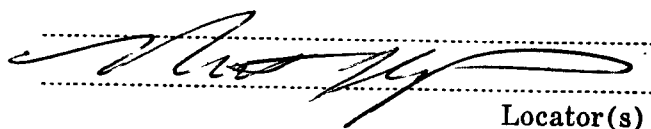

Locator(s)

ARIZONA

Notice of Location

LODE CLAIM

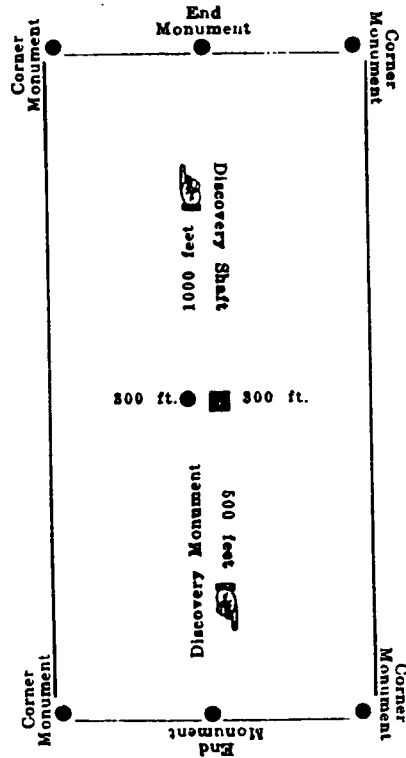

This diagram is to give locator a general idea of plan of location under the new law. The Discovery Shaft can be in the center of claim or any distance from either end desired. In the diagram it is placed 500 feet from one end, and 1000 feet from the other. Commence description of claim at a center end monument, giving its distance and direction from center of Discovery Shaft; thence bound the claim in either direction. In description be careful to state locality of claim with reference to some natural object, or permanent monument, as will identify the claim.

Dated _____, 19.....

STATE OF ARIZONA }
 County of } ss.

I hereby certify that the within instrument was filed and recorded at request of

Book.....

In Docket.....

on page.....

Witness my hand and official seal the day and year aforesaid.

.....
 County Recorder.

By.....
 Deputy Recorder.

PHOENIX, ARIZONA
 2016 DEC - 2 P 3 44
 RECEIVED
 BLM AZ STATE OFFICE

MINING CLAIM MAP

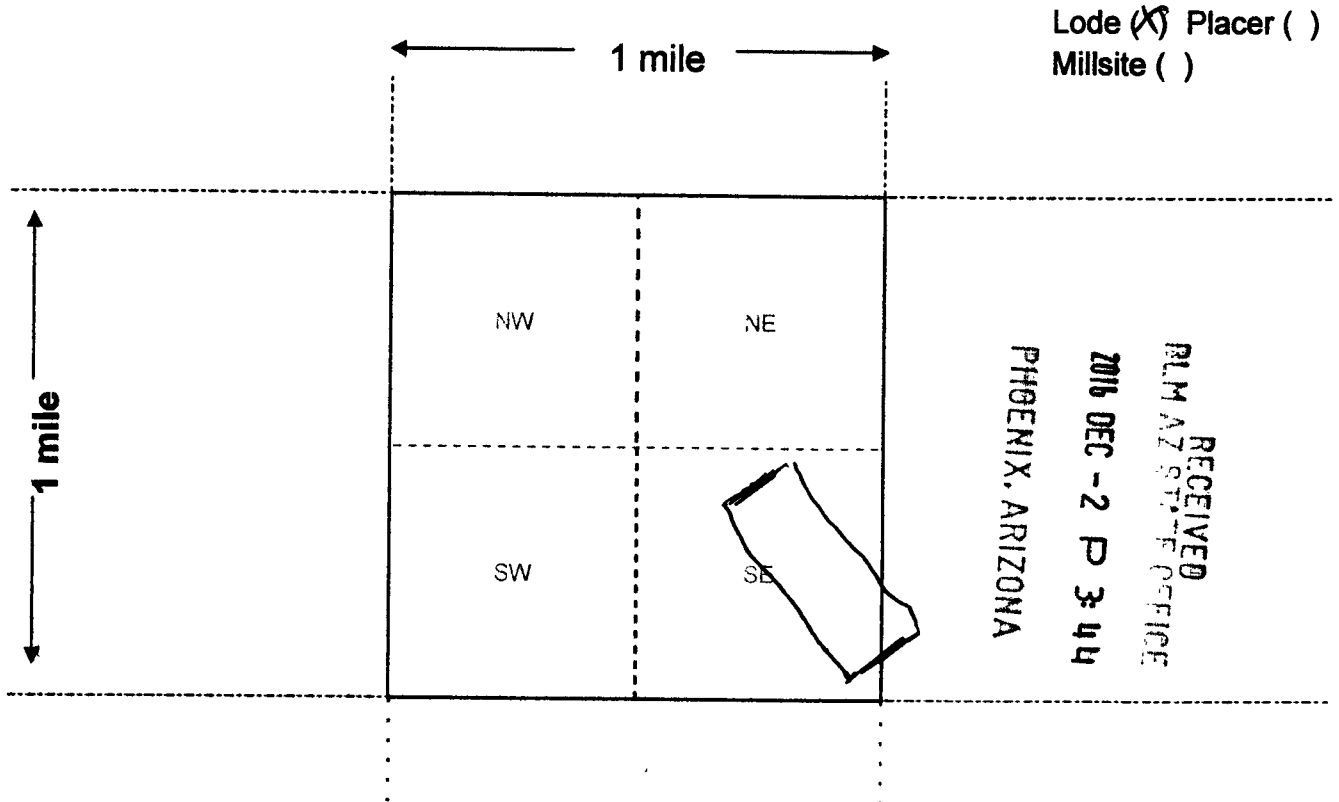

Scale: 1" = 2000 feet

1. The above map depicts the Park #2 mining claim, which is located in Section (s) 7, Township 14 S, Range 27 E, Gila and Salt River Base and Meridian, _____ County, Arizona. Total claim acreage is 20

2. The type of corner and location monuments used are as follows: STONE

3. The bearings and distances in degrees and feet between claim corners and to a public land survey monument are as depicted on the map.

4. If the claim is a placer or millsite claim with exterior limits conforming to legal subdivisions of the public survey, provide a legal description of the claim _____

Form MCF100a
Revised July 2014

AH C 4 4 0 4 0 8

2016-21291

Page 1 of

Requested . . Klump Ranches

Christine Rhodes - Recorder

Cochise County, AZ

11-29-2016 01:24 PM Recording Fee \$9.00

WHEN RECORDED MAIL TO:

Klump Ranches LLC
PO Box 448
Bowie AZ 85605

THE ABOVE SPACE RESERVED FOR RECORDING INFORMATION

CAPTION HEADING

DO NOT REMOVE

THIS IS PART OF THE OFFICIAL DOCUMENT

AMC 11 04 09

RECEIVED
RLM AZ STATE OFFICE
2016 DEC -2 P 3:45
PHOENIX, ARIZONA

Notice of Mining Location

LODE CLAIM

TO ALL WHOM IT MAY CONCERN:

This Mining Claim, the name of which is the

Park #3

Mining Claim, situate on land belonging to the United States of America, and in which there are valuable mineral deposits, was entered upon and located for the purpose of exploration and purchase by

Klump Ranches LLC

PO Box 448 Bowie AZ 85605

(Locator must insert either "A Citizen of the United States," or "Who has declared his intention to become a Citizen of the United States.")

the undersigned, on the 29th day of November

2016

The length of this claim is 1500 feet and 1 claim 270 feet in a easterly direction and 1230 feet in a westerly direction from the center of the discovery shaft, at which this notice is posted, lengthwise of the claim together with 300 feet in width of the surface grounds, on each side of the center of said claim. The general course of the lode deposit and premises is from the easterly to the westerly.

The claim is situated and located in the Tevis Mining District, in

Cochise

county, in the State of Arizona, about

3/4 mile

in a westerly

direction from Das Cabezas Peaks

RECEIVED
CLM & MINING OFFICE
PHOENIX, ARIZONA
2016 DEC -2 P 3:45

The surface boundaries of the claim are marked upon the ground as follows

Beginning at Monument of Stone

at a point in a easterly direction 270 feet from the discovery shaft (at which this notice is posted), being in the center of the easterly

end line of said claim; thence 300 feet to a MONUMENT, being the NE corner of said claim;

thence 1500 feet to a MONUMENT being at the NW corner of said claim; thence 300 feet

to a MONUMENT at the center of the westerly end of this claim; thence 300 feet to a MONUMENT, being at the

SW corner of said claim; thence 1500 feet to a MONUMENT at the SE corner of said claim;

thence 300 feet to the place of beginning.

Dated and posted on the ground this 29th day of November, 2016

Klump Ranches LLC

MATT Klump

Witness

Locator(s)

AMC 11101100

Notice of Location

LODE CLAIM

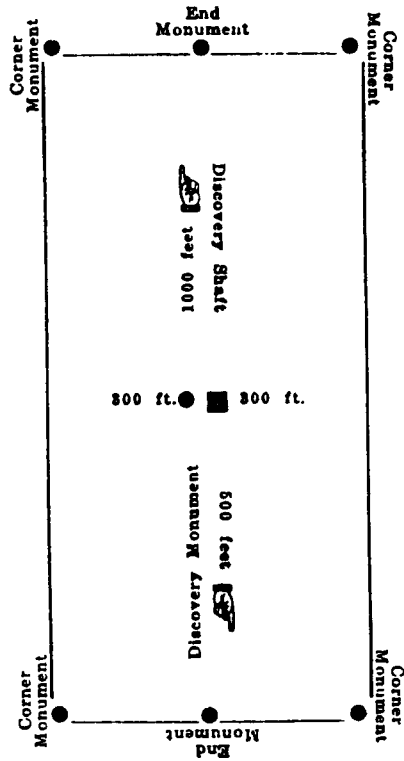

This diagram is to give locator a general idea of plan of location under the new law. The Discovery Shaft can be in the center of claim or any distance from either end desired. In the diagram it is placed 500 feet from one end, and 1000 feet from the other. Commence description of claim at a center end monument, giving its distance and direction from center of Discovery Shaft; thence bound the claim in either direction. In description be careful to state locality of claim with reference to some natural object, or permanent monument, as will identify the claim.

Dated, 19.....

STATE OF ARIZONA }
 County of } ss.

I hereby certify that the within instrument was filed and recorded at request of

Book.....

In Docket.....

on page.....

Witness my hand and official seal the day and year aforesaid.

.....
 County Recorder.

By.....
 Deputy Recorder.

PHOENIX, ARIZONA
 2016 DEC - 2 P 3:45
 RECEIVED
 PLM AZ STATE OFFICE

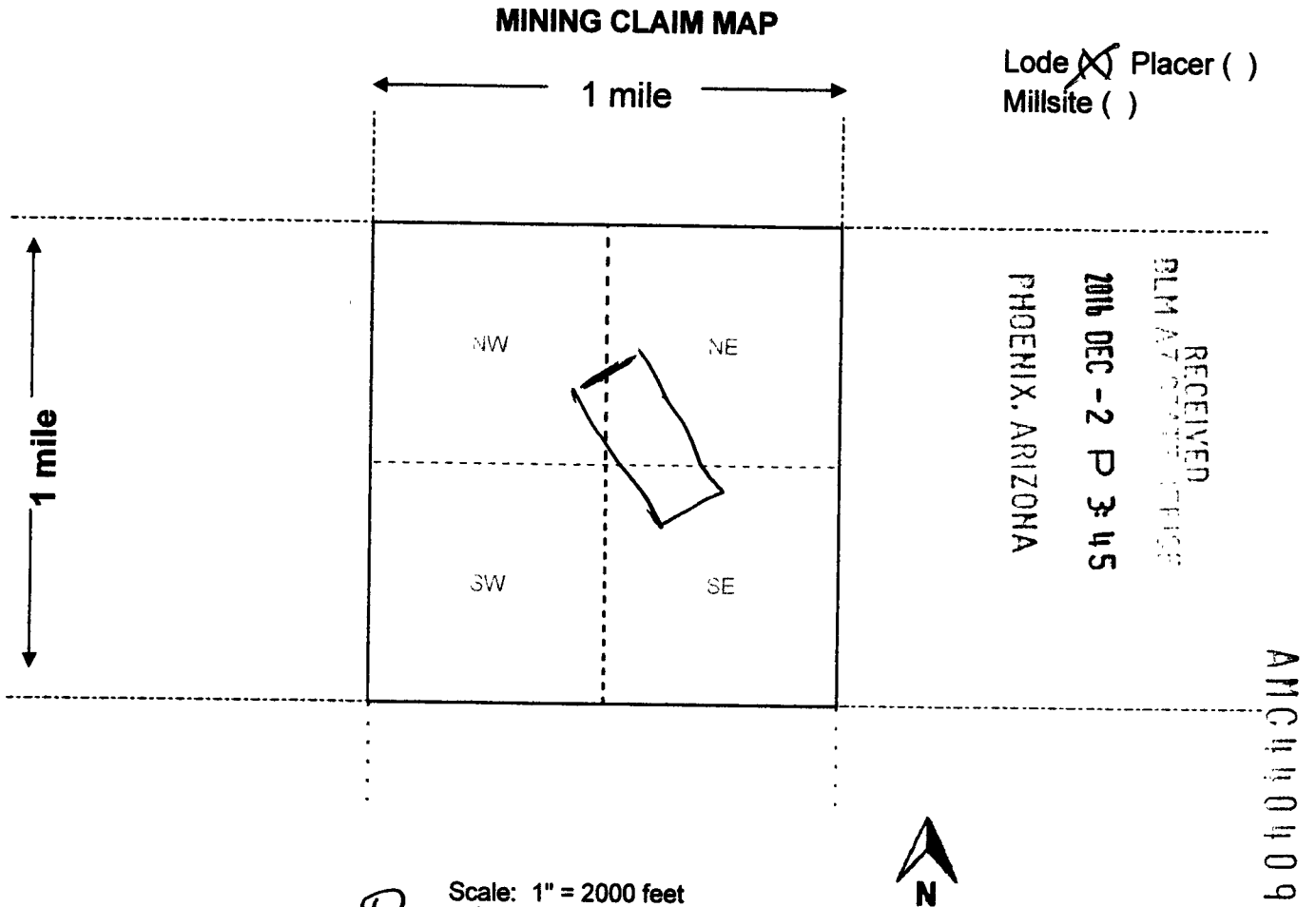

1. The above map depicts the Park #3 mining claim, which is located in Section (s) 7, Township 14 S, Range 27 E, Gila and Salt River Base and Meridian, _____ County, Arizona. Total claim acreage is 20
2. The type of corner and location monuments used are as follows: STONE
3. The bearings and distances in degrees and feet between claim corners and to a public land survey monument are as depicted on the map.
4. If the claim is a placer or millsite claim with exterior limits conforming to legal subdivisions of the public survey, provide a legal description of the claim _____

Form MCF100a
Revised July 2014

2016-01292

Page 1 of

Requested by: Klump Ranches

Christine Rhodes - Recorder

Cochise County, AZ

11-29-2016 01:24 PM Recording Fee \$9.00

WHEN RECORDED MAIL TO:

Klump Ranches LLC
PO Box 448
Bowie AZ 85605

THE ABOVE SPACE RESERVED FOR RECORDING INFORMATION

CAPTION HEADING

DO NOT REMOVE

THIS IS PART OF THE OFFICIAL DOCUMENT

RECEIVED
RLM AZ RECORDER OFFICE
2016 DEC -2 P 3:45
PHOENIX, ARIZONA

AMC440410

Notice of Mining Location

LODE CLAIM

TO ALL WHOM IT MAY CONCERN:

This Mining Claim, the name of which is the Park # 4

Mining Claim, situate on land belonging to the United States of America, and in which there are valuable mineral deposits, was entered upon and located for the purpose of exploration and purchase by

Klump Ranches LLC
PO Box 448 Bowie AZ 85605

(Locator must insert either "A Citizen of the United States," or "Who has declared his intention to become a Citizen of the United States.")
the undersigned, on the 29th day of November, 2016

The length of this claim is 1500 feet and 1 claim 110 feet in a easterly direction and 1390 feet in a westerly direction from the center of the discovery shaft, at which this notice is posted, lengthwise of the claim together with 300 feet in width of the surface grounds, on each side of the center of said claim. The general course of the lode deposit and premises is from the easterly to the westerly

The claim is situated and located in the Tevis Mining District, in Cochise county, in the State of Arizona, about 3/4 mile in a westerly direction from Dos Cabezas Peaks

The surface boundaries of the claim are marked upon the ground as follows:
Beginning at Monument of stone
at a point in a easterly direction 110 feet from the discovery shaft (at which this notice is posted), being in the center of the easterly

end line of said claim; thence 300 feet to a Monument, being the NE corner of said claim; thence 1500 feet to a Monument being at the NW corner of said claim; thence 300 feet to a Monument at the center of the westerly end of this claim; thence 300 feet to a Monument, being at the SW corner of said claim; thence 1500 feet to a Monument at the SE corner of said claim; thence 300 feet to the place of beginning.

Dated and posted on the ground this 29th day of November, 2016

Klump Ranches LLC
Matt Klump
Witness

[Signature]
Locator(s)

RECEIVED
PLM
2016 DEC - 2 P 3 45
PHOENIX ARIZONA
ARCHITECT

Notice of Location

LODE CLAIM

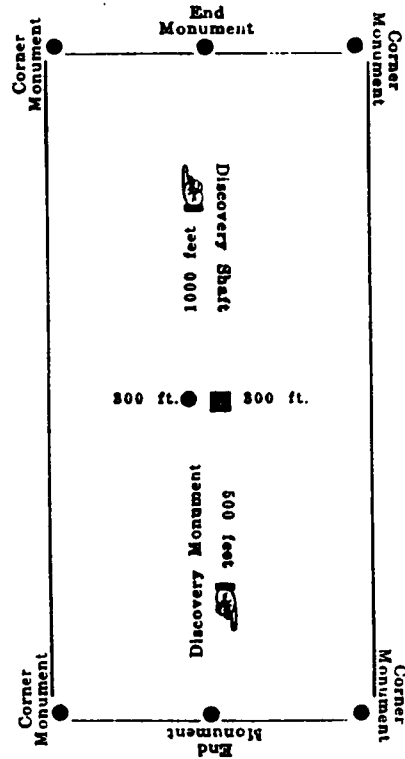

This diagram is to give locator a general idea of plan of location under the new law. The Discovery Shaft can be in the center of claim or any distance from either end desired. In the diagram it is placed 500 feet from one end, and 1000 feet from the other. Commence description of claim at a center end monument, giving its distance and direction from center of Discovery Shaft; thence bound the claim in either direction. In description be careful to state locality of claim with reference to some natural object, or permanent monument, as will identify the claim.

Dated, 19.....

STATE OF ARIZONA }
 County of } ss.

I hereby certify that the within instrument was filed and recorded at request of

Book.....

In Docket.....

on page.....

Witness my hand and official seal the day and year aforesaid.

.....
 County Recorder.

By.....
 Deputy Recorder.

PHOENIX, ARIZONA
 2016 DEC - 2 P 3:45
 RECEIVED
 BLM AZ STATE OFFICE

MINING CLAIM MAP

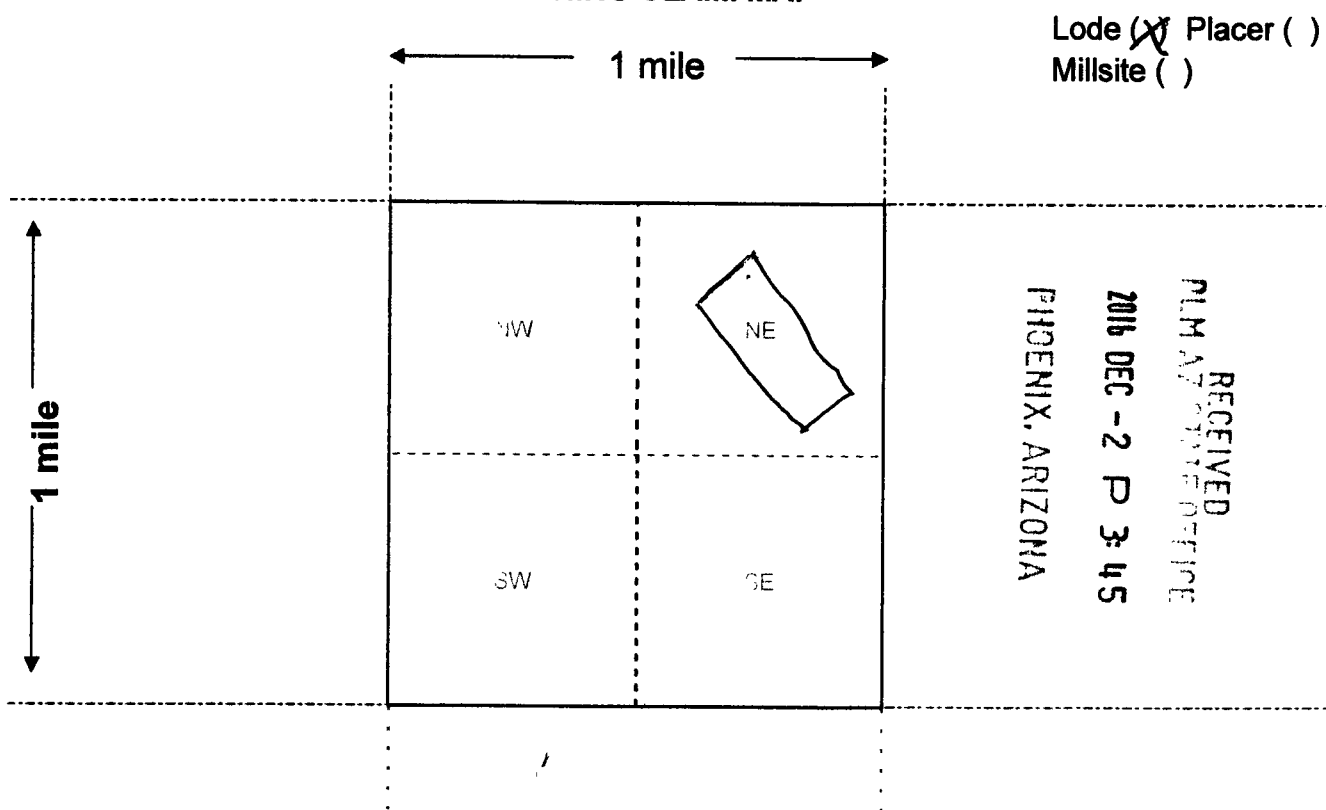

Scale: 1" = 2000 feet



1. The above map depicts the Park # 4 mining claim, which is located in Section (s) 7, Township 14 S, Range 27 E, Gila and Salt River Base and Meridian, _____ County, Arizona. Total claim acreage is 20

2. The type of corner and location monuments used are as follows: STONE

3. The bearings and distances in degrees and feet between claim corners and to a public land survey monument are as depicted on the map.

4. If the claim is a placer or millsite claim with exterior limits conforming to legal subdivisions of the public survey, provide a legal description of the claim _____

Form MCF100a
Revised July 2014

AMC 1110410

WHEN RECORDED MAIL TO:

Klump Ranches LLC
PO Box 448
Bowie AZ 85605

THE ABOVE SPACE RESERVED FOR RECORDING INFORMATION

CAPTION HEADING

DO NOT REMOVE

THIS IS PART OF THE OFFICIAL DOCUMENT

RECEIVED
BLM AT TONTO OFFICE
2016 DEC -2 P 3:49
PHOENIX, ARIZONA

AMC140411

Notice of Mining Location

LODE CLAIM

TO ALL WHOM IT MAY CONCERN:

This Mining Claim, the name of which is the Park # 5

Mining Claim, situate on land belonging to the United States of America, and in which there are valuable mineral deposits, was entered upon and located for the purpose of exploration and purchase by

Klump Ranches LLC
PO Box 448 Bowie AZ 85605

(Locator must insert either "A Citizen of the United States," or "Who has declared his intention to become a Citizen of the United States.")
the undersigned, on the 29th day of November, 2016

The length of this claim is 1500 feet and 1 claim 1320 feet in a Easterly direction and 180 feet in a Westerly direction from the center of the discovery shaft, at which this notice is posted, lengthwise of the claim together with 300 feet in width of the surface grounds, on each side of the center of said claim. The general course of the lode deposit and premises is from the easterly to the westerly.

The claim is situated and located in the Tevis Mining District, in Cochise county, in the State of Arizona, about 3 1/4 mile in a westerly direction from Dos Cabezas Peaks

RECEIVED
MINING DISTRICT OFFICE
PHOENIX, ARIZONA
2016 DEC - 2 P 3:45

AMCH 1104

The surface boundaries of the claim are marked upon the ground as follows:
Beginning at MONUMENT

at a point in a westerly direction 180 feet from the discovery shaft (at which this notice is posted), being in the center of the westerly

end line of said claim; thence 300 feet to a _____, being the SW corner of said claim;

thence 1500 feet to a MONUMENT being at the SE corner of said claim; thence 300 feet

to a MONUMENT at the center of the easterly end of this claim; thence 300 feet to a MONUMENT, being at the

NE corner of said claim; thence 1500 feet to a MONUMENT at the NW corner of said claim;

thence 300 feet to the place of beginning.

Dated and posted on the ground this 29th day of November, 2016

Klump Ranches LLC
MATT KLUMP
Witness

[Signature]
Locator(s)

Notice of Location

LODE CLAIM

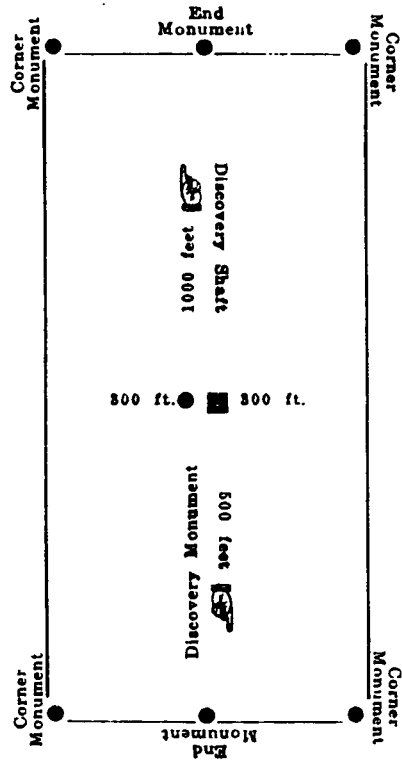

This diagram is to give locator a general idea of plan of location under the new law. The Discovery Shaft can be in the center of claim or any distance from either end desired. In the diagram it is placed 500 feet from one end, and 1000 feet from the other. Commence description of claim at a center end monument, giving its distance and direction from center of Discovery Shaft; thence bound the claim in either direction. In description be careful to state locality of claim with reference to some natural object, or permanent monument, as will identify the claim.

Dated, 19.....

STATE OF ARIZONA }
 County of } ss.

I hereby certify that the within instrument was filed and recorded at request of

Book.....

In Docket.....

on page.....

Witness my hand and official seal the day and year aforesaid.

County Recorder.

By.....

Deputy Recorder.

PHOENIX, ARIZONA
 2016 DEC - 2 P 3 45
 RECEIVED
 CLM AZ STATE OFFICE

MINING CLAIM MAP

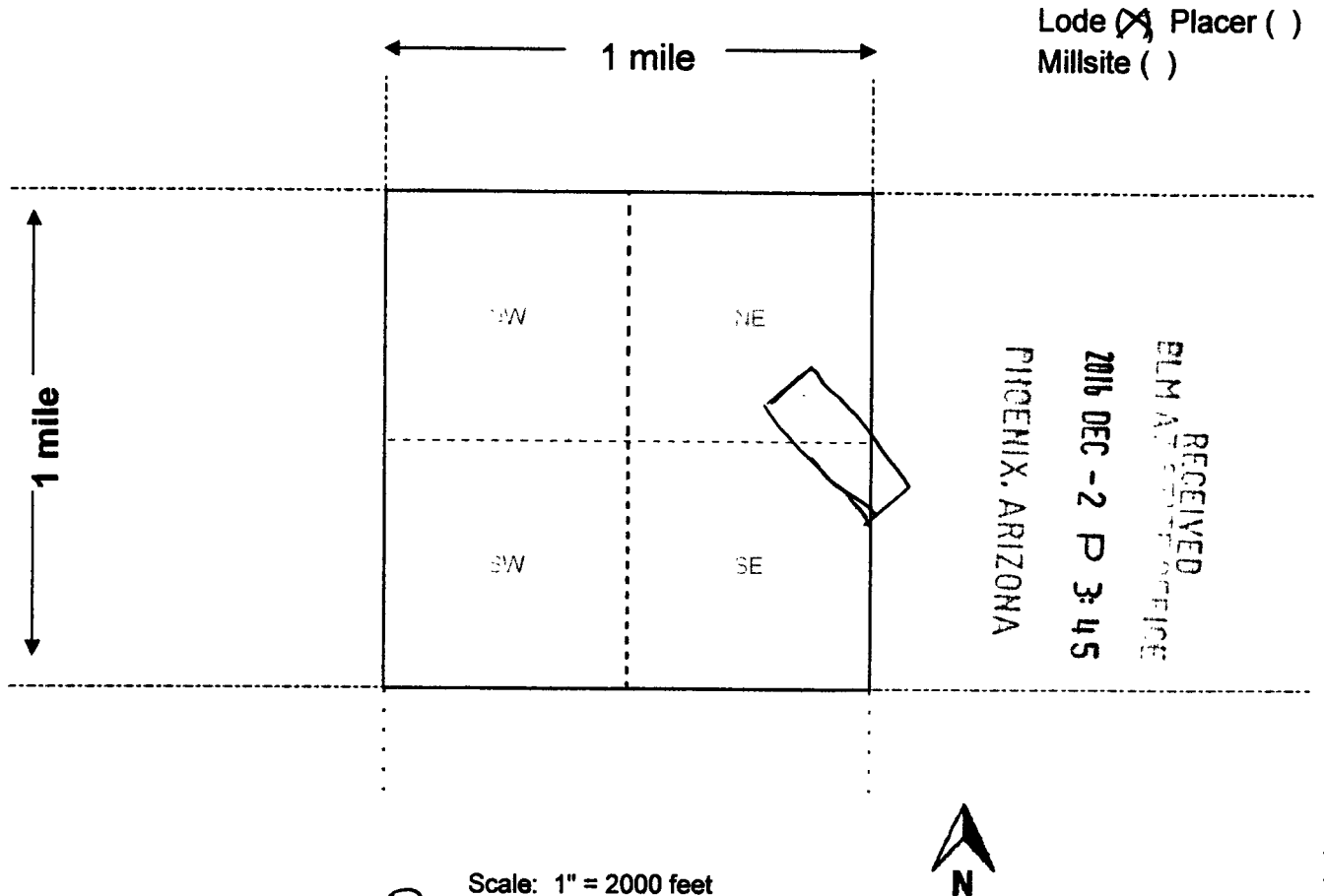

Scale: 1" = 2000 feet

1. The above map depicts the Park # 5 mining claim, which is located in Section (s) 7, Township 14 S, Range 27 E, Gila and Salt River Base and Meridian, _____ County, Arizona. Total claim acreage is 20

2. The type of corner and location monuments used are as follows: STONE

3. The bearings and distances in degrees and feet between claim corners and to a public land survey monument are as depicted on the map.

4. If the claim is a placer or millsite claim with exterior limits conforming to legal subdivisions of the public survey, provide a legal description of the claim _____

Form MCF100a
Revised July 2014

2016-21294

Page 1 of

Requested by: Klump Ranches

Christine Rhodes - Recorder

Cochise County, AZ

11-29-2016 01:24 PM Recording Fee \$9.00

WHEN RECORDED MAIL TO:

Klump Ranches LLC
PO Box 448
Bowie AZ 85605

THE ABOVE SPACE RESERVED FOR RECORDING INFORMATION

CAPTION HEADING

DO NOT REMOVE

THIS IS PART OF THE OFFICIAL DOCUMENT

PHOENIX, ARIZONA

2016 DEC - 2 P 3:46

RECEIVED
PLM AZ STATE OFFICE

ANCI110412

Notice of Mining Location

LODE CLAIM

TO ALL WHOM IT MAY CONCERN:

This Mining Claim, the name of which is the Park #6

Mining Claim, situate on land belonging to the United States of America, and in which there are valuable mineral deposits, was entered upon and located for the purpose of exploration and purchase by

Klump Ranches LLC
PO Box 448 Bowie AZ 85605

(Locator must insert either "A Citizen of the United States," or "Who has declared his intention to become a Citizen of the United States.")
the undersigned, on the 29th day of November, 2016

The length of this claim is 1500 feet and I claim 900 feet in a easterly direction and 600 feet in a westerly direction from the center of the discovery shaft, at which this notice is posted, lengthwise of the claim together with 300 feet in width of the surface grounds, on each side of the center of said claim. The general course of the lode deposit and premises is from the easterly to the West

The claim is situated and located in the Trevi's Mining District, in Cochise county, in the State of Arizona, about 3/4 mile in a westerly direction from Dos Cabezas Peaks

RECEIVED
MILM AZ STATE OFFICE
2016 DEC -2 P 3:46
PHOENIX, ARIZONA

AMC1140412

The surface boundaries of the claim are marked upon the ground as follows
Beginning at MONUMENT

at a point in a westerly direction 600 feet from the discovery shaft (at which this notice is posted), being in the center of the westerly

end line of said claim; thence 300 feet to a MONUMENT, being the SW corner of said claim;

thence 1500 feet to a MONUMENT being at the SE corner of said claim; thence 300 feet

to a MONUMENT at the center of the easterly end of this claim;

thence 300 feet to a MONUMENT, being at the NE corner of said claim; thence 1500 feet

to a MONUMENT at the NW corner of said claim; thence 300 feet to the place of beginning.

Dated and posted on the ground this 29th day of November, 2016

Klump Ranches LLC
MATT KLUMP

Witness

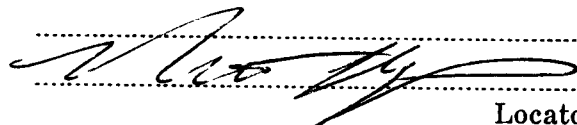

Locator(s)

Notice of Location

LODE CLAIM

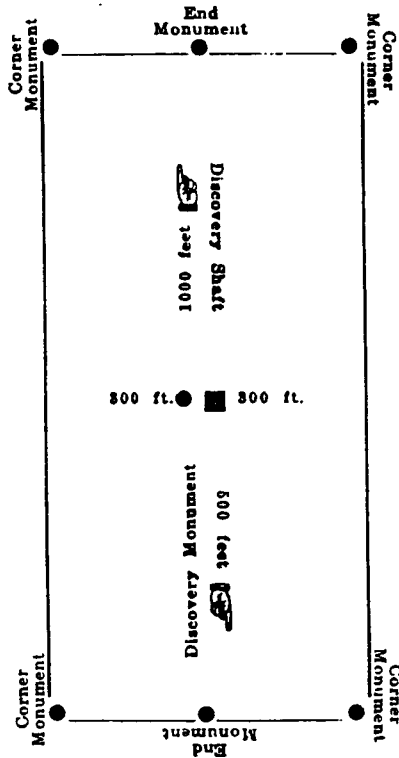

This diagram is to give locator a general idea of plan of location under the new law. The Discovery Shaft can be in the center of claim or any distance from either end desired. In the diagram it is placed 500 feet from one end, and 1000 feet from the other. Commence description of claim at a center end monument, giving its distance and direction from center of Discovery Shaft; thence bound the claim in either direction. In description be careful to state locality of claim with reference to some natural object, or permanent monument, as will identify the claim.

Dated, 19.....

STATE OF ARIZONA }
 County of } ss.

I hereby certify that the within instrument was filed and recorded at request of

Book.....
 In Docket.....
 on page.....

Witness my hand and official seal the day and year aforesaid.

.....
 County Recorder.

By.....
 Deputy Recorder.

PHOENIX, ARIZONA
 2016 DEC - 2 P 3:46
 RECEIVED
 PLM AZ STATE OFFICE

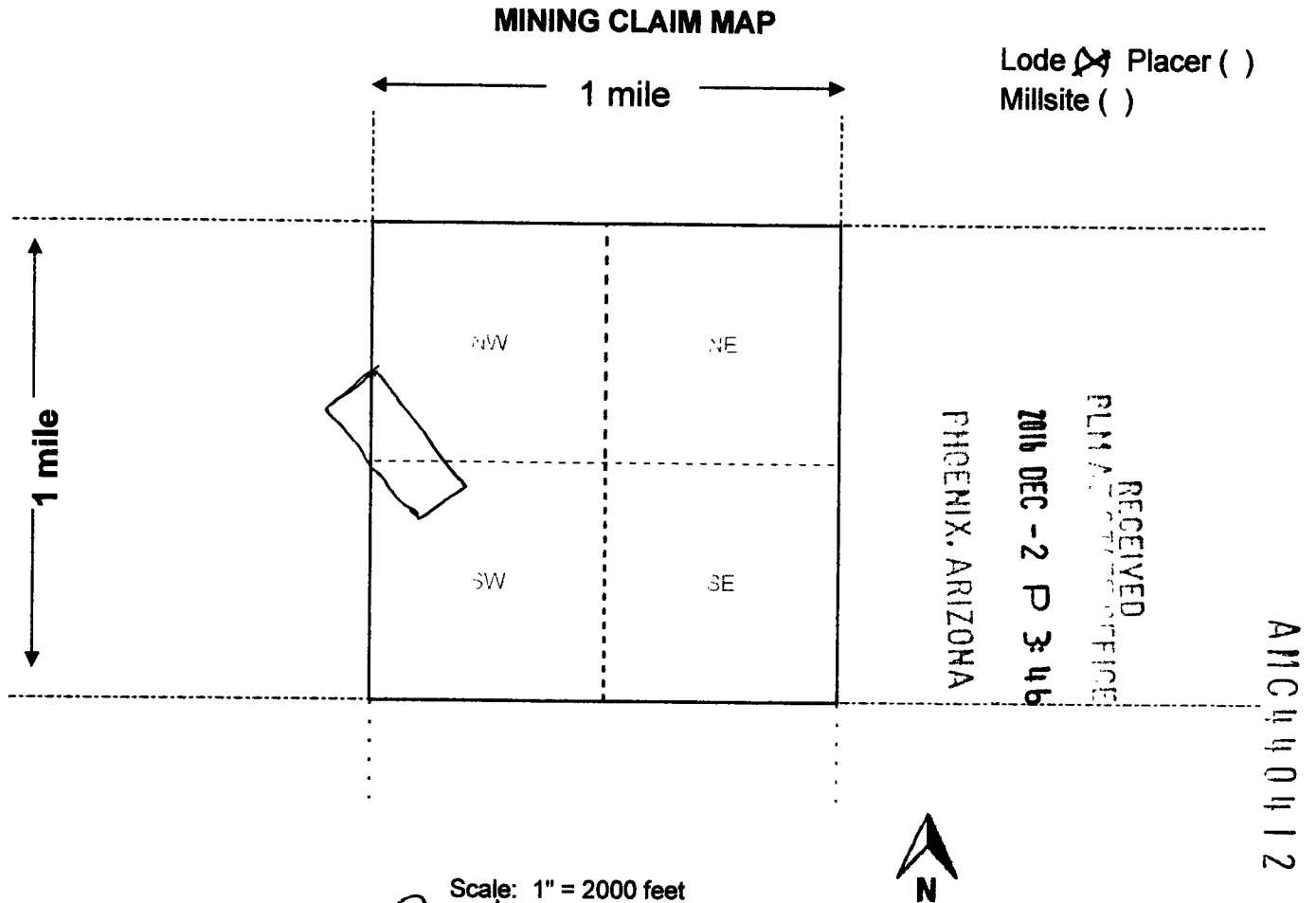

Scale: 1" = 2000 feet

1. The above map depicts the PARK # 6 mining claim, which is located in Section (s) 7+8, Township 14 S, Range 27 E, Gila and Salt River Base and Meridian, _____ County, Arizona. Total claim acreage is 20
2. The type of corner and location monuments used are as follows: STONE
3. The bearings and distances in degrees and feet between claim corners and to a public land survey monument are as depicted on the map.
4. If the claim is a placer or millsite claim with exterior limits conforming to legal subdivisions of the public survey, provide a legal description of the claim _____

Form MCF100a
Revised July 2014

WHEN RECORDED MAIL TO:

Klump Ranches LLC
PO Box 448
Bowie AZ 85605

THE ABOVE SPACE RESERVED FOR RECORDING INFORMATION

CAPTION HEADING

DO NOT REMOVE

THIS IS PART OF THE OFFICIAL DOCUMENT

RECEIVED
PLM AD REGISTERED OFFICE
2016 DEC - 2 P 3:46
PHOENIX, ARIZONA

AMC440413

Notice of Mining Location

LODE CLAIM

TO ALL WHOM IT MAY CONCERN:

This Mining Claim, the name of which is the Park # 7

Mining Claim, situate on land belonging to the United States of America, and in which there are valuable mineral deposits, was entered upon and located for the purpose of exploration and purchase by

Klump Ranches LLC

PO Box 448 Bowie AZ 85605

(Locator must insert either "A Citizen of the United States," or "Who has declared his intention to become a Citizen of the United States.") the undersigned, on the 29 day of November, 2016

The length of this claim is 1500 feet and 1 claim 100 feet in a easterly direction and 1400 feet in a Westerly direction from the center of the discovery shaft, at which this notice is posted, lengthwise of the claim together with 300 feet in width of the surface grounds, on each side of the center of said claim. The general course of the lode deposit and premises is from the easterly to the Westerly

The claim is situated and located in the Tevis Mining District, in Cochise county, in the State of Arizona, about 3/4 mile in a Westerly direction from Dos Cabezas Peaks

RECEIVED
BIM AZ STATE OFFICE
2016 DEC - 2 P 3:46
PHOENIX, ARIZONA

AMC 111113

The surface boundaries of the claim are marked upon the ground as follows: Beginning at MONUMENT OF Stone

at a point in a easterly direction 100 feet from the discovery shaft (at which this notice is posted), being in the center of the easterly

end line of said claim; thence 300 feet to a MONUMENT, being the NW corner of said claim;

thence 1500 feet to a MONUMENT being at the NW corner of said claim; thence 300 feet

to a MONUMENT at the center of the Westerly end of this claim; thence 300 feet to a MONUMENT, being at the

SW corner of said claim; thence 1500 feet to a MONUMENT at the SE corner of said claim;

thence 300 feet to the place of beginning.

Dated and posted on the ground this 29th day of November, 2016

Klump Ranches LLC
MATT KLUMP

Witness

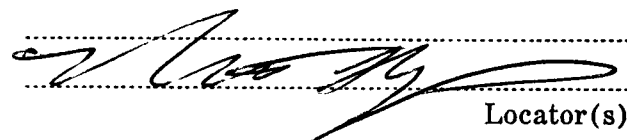

Locator(s)

Notice of Location

LODE CLAIM

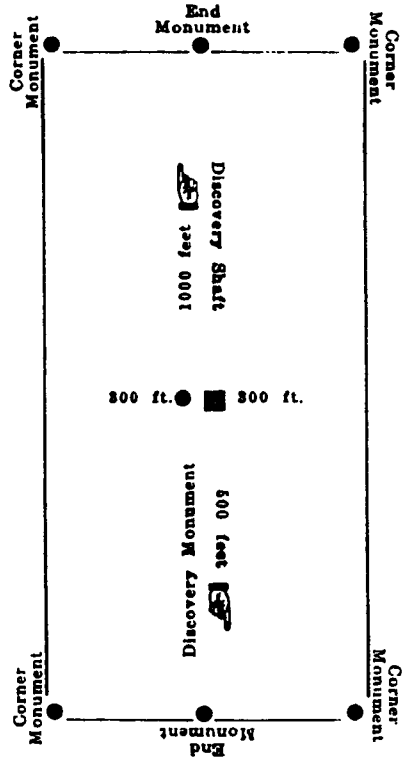

This diagram is to give locator a general idea of plan of location under the new law. The Discovery Shaft can be in the center of claim or any distance from either end desired. In the diagram it is placed 500 feet from one end, and 1000 feet from the other. Commence description of claim at a center end monument, giving its distance and direction from center of Discovery Shaft; thence bound the claim in either direction. In description be careful to state locality of claim with reference to some natural object, or permanent monument, as will identify the claim.

Dated, 19.....

STATE OF ARIZONA }
 County of } ss.

I hereby certify that the within instrument was filed and recorded at request of

Book.....
 In Docket.....
 on page.....

Witness my hand and official seal the day and year aforesaid.

.....
 County Recorder.

By.....
 Deputy Recorder.

PHOENIX, ARIZONA
 2016 DEC - 2 P 3 46
 RECEIVED
 CLERK'S OFFICE

MINING CLAIM MAP

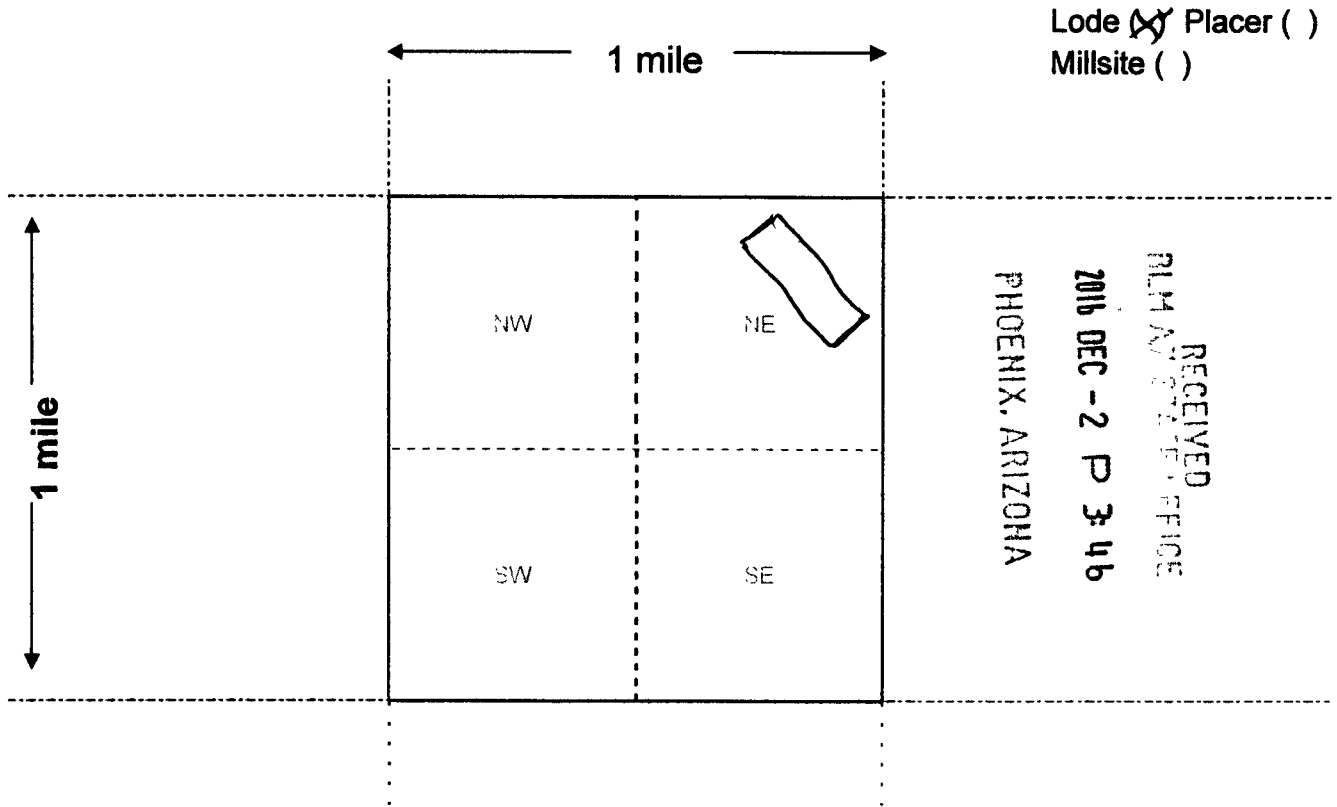

Scale: 1" = 2000 feet



1. The above map depicts the Park # 7 mining claim, which is located in Section (s) 7, Township 14 S, Range 27 E, Gila and Salt River Base and Meridian, _____ County, Arizona. Total claim acreage is 20

2. The type of corner and location monuments used are as follows: Stone

3. The bearings and distances in degrees and feet between claim corners and to a public land survey monument are as depicted on the map.

4. If the claim is a placer or millsite claim with exterior limits conforming to legal subdivisions of the public survey, provide a legal description of the claim _____

Form MCF100a
Revised July 2014

AMC 140413

2016-21296

Page 1 of

Requested : Klump Ranches

Christine Rhodes - Recorder

Cochise County, AZ

11-29-2016 01:24 PM Recordings Fee \$9.00

WHEN RECORDED MAIL TO:

Klump Ranches LLC
PO Box 448
Bowie AZ 85605

THE ABOVE SPACE RESERVED FOR RECORDING INFORMATION

CAPTION HEADING

DO NOT REMOVE

THIS IS PART OF THE OFFICIAL DOCUMENT

RECEIVED
CLM AZ STATE OFFICE
2016 DEC - 2 P 3:46
PHOENIX, ARIZONA

AMC110414

Notice of Mining Location

LODE CLAIM

TO ALL WHOM IT MAY CONCERN:

This Mining Claim, the name of which is the Park # 8

Mining Claim, situate on land belonging to the United States of America, and in which there are valuable mineral deposits, was entered upon and located for the purpose of exploration and purchase by

Klump Ranches LLC
Box 448 Bowie AZ 85605

(Locator must insert either "A Citizen of the United States," or "Who has declared his intention to become a Citizen of the United States.")
the undersigned, on the 29 day of November, ~~2015~~ 2016

The length of this claim is 1500 feet and 1 claim 100 feet in a easterly direction and 1400 feet in a westerly direction from the center of the discovery shaft, at which this notice is posted, lengthwise of the claim together with 300 feet in width of the surface grounds, on each side of the center of said claim. The general course of the lode deposit and premises is from the easterly to the westerly

The claim is situated and located in the Tevis Mining District, in Cochise county, in the State of Arizona, about 3/4 mile in a westerly direction from Dos Cabezas Peaks

The surface boundaries of the claim are marked upon the ground as follows. Beginning at Monument of stone

at a point in a easterly direction 100 feet from the discovery shaft (at which this notice is posted), being in the center of the easterly

end line of said claim; thence 300 feet to a Monument, being the NE corner of said claim;

thence 1500 feet to a Monument being at the NW corner of said claim; thence 300 feet

to a Monument at the center of the westerly end of this claim; thence 300 feet to a Monument, being at the

SW corner of said claim; thence 1500 feet to a Monument at the SE corner of said claim;

thence 300 feet to the place of beginning.

Dated and posted on the ground this 29th day of November, ~~2015~~ 2016

Klump Ranches LLC
MATT KLUMP

Witness

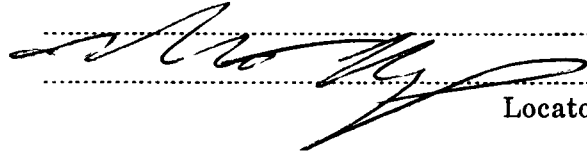

Locator(s)

RECEIVED
DIME & SHAW
PHOENIX, ARIZONA
2016 DEC - 2 P 3:44

AMC 440414

Notice of Location

LODE CLAIM

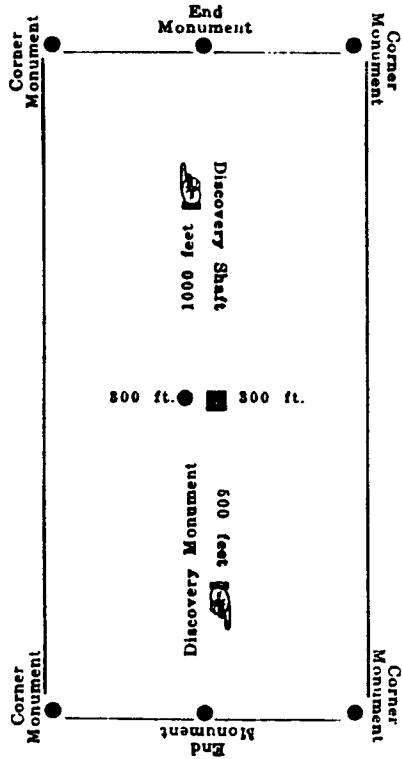

This diagram is to give locator a general idea of plan of location under the new law. The Discovery Shaft can be in the center of claim or any distance from either end desired. In the diagram it is placed 500 feet from one end, and 1000 feet from the other. Commence description of claim at a center end monument, giving its distance and direction from center of Discovery Shaft; thence bound the claim in either direction. In description be careful to state locality of claim with reference to some natural object, or permanent monument, as will identify the claim.

Dated, 19.....

STATE OF ARIZONA }
 County of } ss.

I hereby certify that the within instrument was filed and recorded at request of

Book.....

In Docket.....

on page.....

Witness my hand and official seal PHOENIX, ARIZONA the day and year aforesaid.

.....
 County Recorder.

By.....
 Deputy Recorder.

RECEIVED
 PLM AZ STATE OFFICE
 2016 DEC - 2 P 3:46

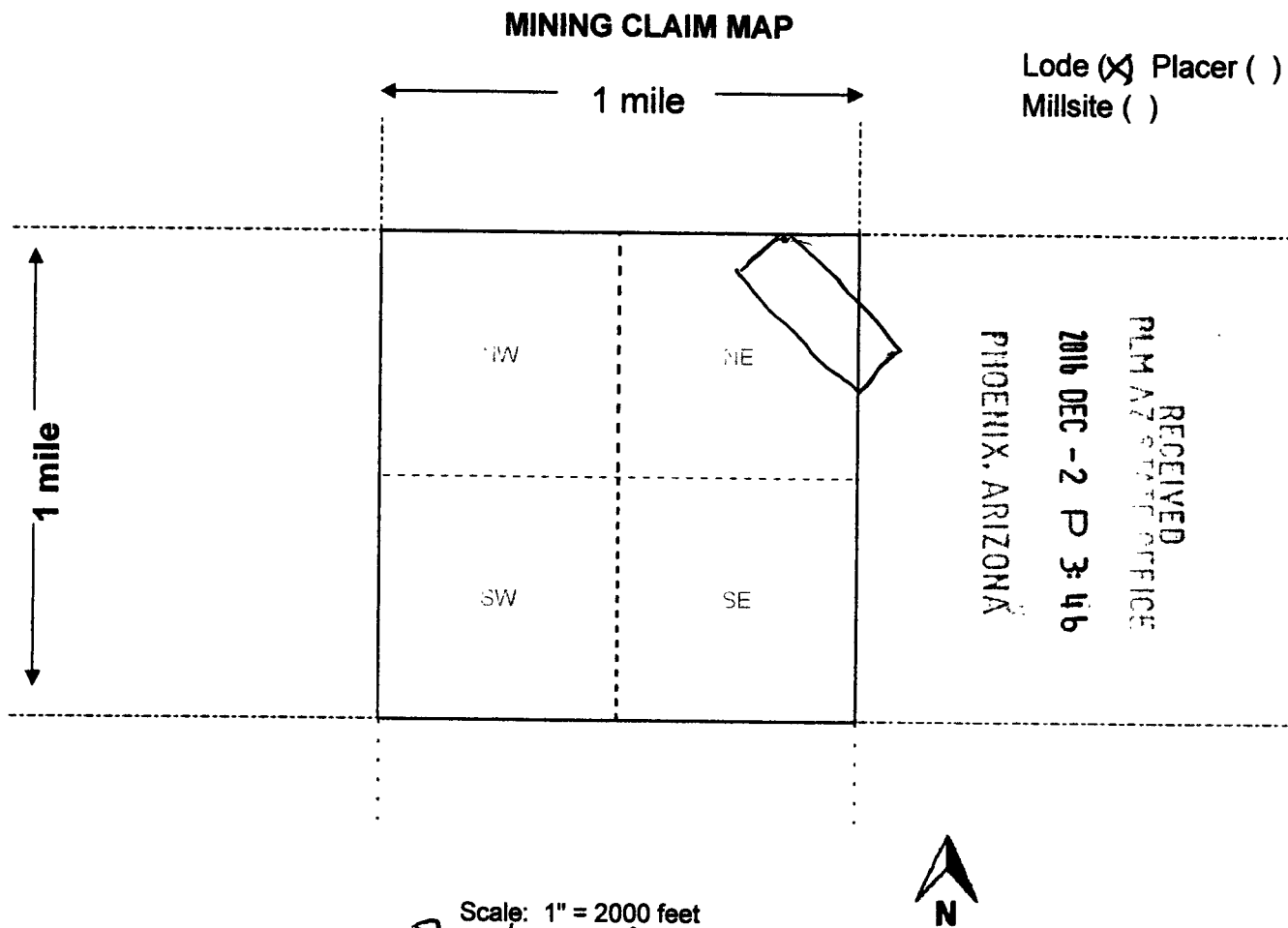

AMC 1140414

1. The above map depicts the Park # 8 mining claim, which is located in Section (s) 7, Township 14 S, Range 27 E, Gila and Salt River Base and Meridian, _____ County, Arizona. Total claim acreage is 20
2. The type of corner and location monuments used are as follows: STONE
3. The bearings and distances in degrees and feet between claim corners and to a public land survey monument are as depicted on the map.
4. If the claim is a placer or millsite claim with exterior limits conforming to legal subdivisions of the public survey, provide a legal description of the claim _____

2016-21297

Page 1 of 7

Requested By Klump Ranches

Christine Rhodes - Recorder

Cochise County, AZ

11-29-2016 01:24 PM Recording Fee \$9.00

WHEN RECORDED MAIL TO:

Klump Ranches LLC
PO Box 448
Bowie AZ 85605

THE ABOVE SPACE RESERVED FOR RECORDING INFORMATION

CAPTION HEADING

DO NOT REMOVE

THIS IS PART OF THE OFFICIAL DOCUMENT

PHOENIX, ARIZONA

2016 DEC - 2 P 3:46

RECEIVED
PLM AZ STATE OFFICE

AHC1440415

Notice of Mining Location

LODE CLAIM

TO ALL WHOM IT MAY CONCERN:

This Mining Claim, the name of which is the Park # 9

Mining Claim, situate on land belonging to the United States of America, and in which there are valuable mineral deposits, was entered upon and located for the purpose of exploration and purchase by

Klump Ranches LLC
PO Box 448 Bowie AZ 85605

(Locator must insert either "A Citizen of the United States," or "Who has declared his intention to become a Citizen of the United States,")
the undersigned, on the 29th day of November, 2016

The length of this claim is 1500 feet and 1 claim 100 feet in a easterly direction and 1400 feet in a westerly direction from the center of the discovery shaft, at which this notice is posted, lengthwise of the claim together with 300 feet in width of the surface grounds, on each side of the center of said claim. The general course of the lode deposit and premises is from the easterly to the westerly

The claim is situated and located in the Tevlis Mining District, in Cochise county, in the State of Arizona, about 3 1/4 mile in a westerly direction from Dos Cabezas Tanks

RECEIVED
DEC - 2 P 3 41
PHOENIX, ARIZONA

ANCL 110415

The surface boundaries of the claim are marked upon the ground as follows
Beginning at MONUMENT OF STONE

at a point in a easterly direction 100 feet from the discovery shaft (at which this notice is posted), being in the center of the easterly

end line of said claim; thence 300 feet to a MONUMENT, being the NE corner of said claim;

thence 1500 feet to a MONUMENT being at the NW corner of said claim; thence 300 feet

to a MONUMENT at the center of the westerly end of this claim; thence 300 feet to a MONUMENT, being at the

SW corner of said claim; thence 1500 feet to a MONUMENT at the SE corner of said claim;

thence 300 feet to the place of beginning.

Dated and posted on the ground this 29th day of November, 2016

Klump Ranches LLC
MATT KLUMP

Witness

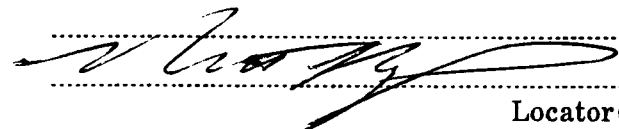

Locator(s)

Notice of Location

LODE CLAIM

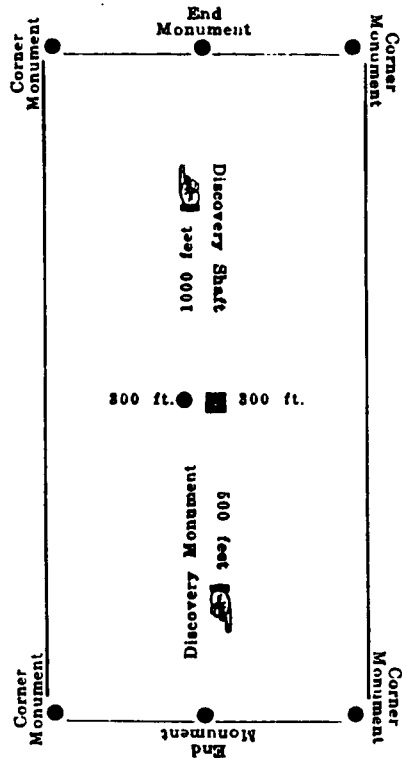

This diagram is to give locator a general idea of plan of location under the new law. The Discovery Shaft can be in the center of claim or any distance from either end desired. In the diagram it is placed 500 feet from one end, and 1000 feet from the other. Commence description of claim at a center end monument, giving its distance and direction from center of Discovery Shaft; thence bound the claim in either direction. In description be careful to state locality of claim with reference to some natural object, or permanent monument, as will identify the claim.

.....

Dated, 19.....

STATE OF ARIZONA }
 County of } ss.

I hereby certify that the within instrument was filed and recorded at request of

Book.....

In Docket.....

on page.....

Witness my hand and official seal the day and year aforesaid.

.....
 County Recorder.

By.....
 Deputy Recorder.

ARIZONA, PHOENIX
 2016 DEC - 2 P 3:47
 RECEIVED
 BLM AZ STATE OFFICE

MINING CLAIM MAP

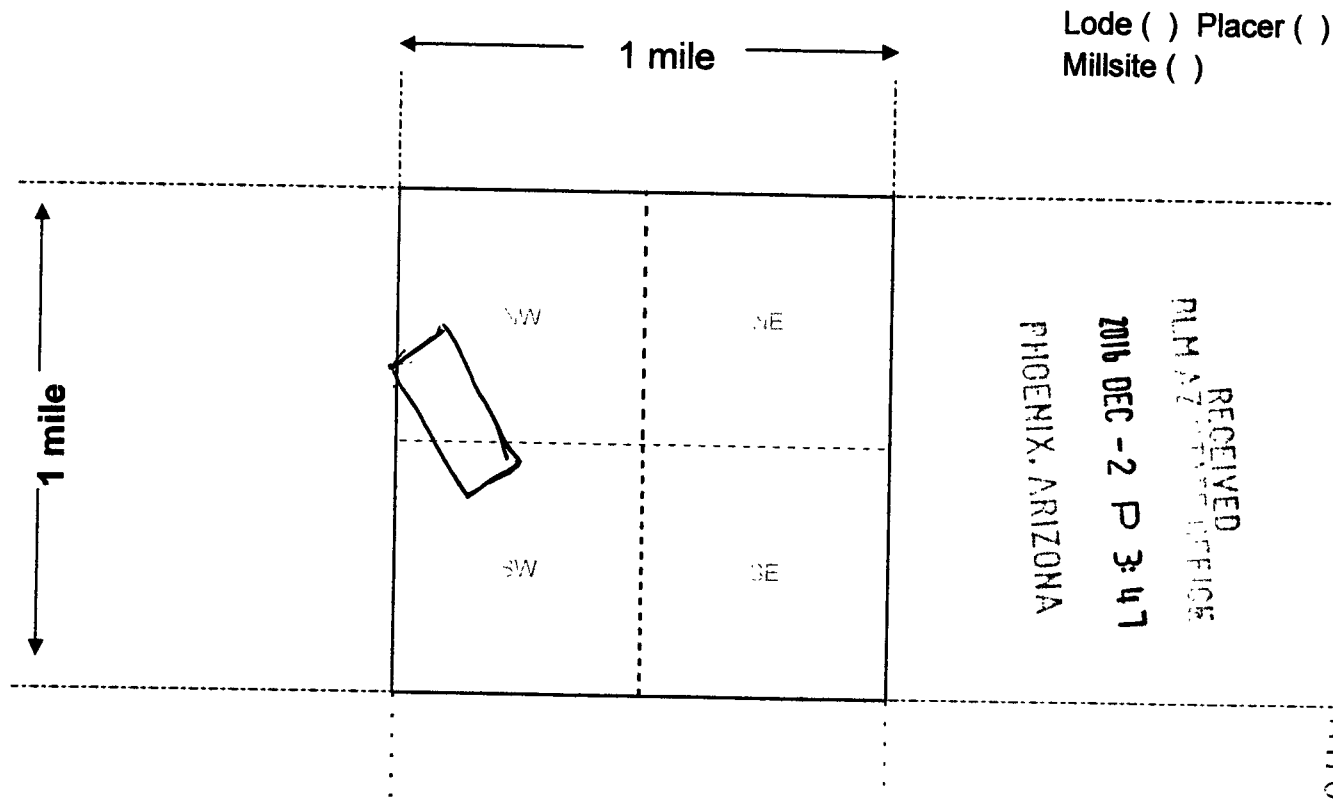

Scale: 1" = 2000 feet

1. The above map depicts the PARK #9 mining claim, which is located in Section (s) 8, Township 14 S, Range 27 E, Gila and Salt River Base and Meridian, _____ County, Arizona. Total claim acreage is 20

2. The type of corner and location monuments used are as follows: Monument of stone

3. The bearings and distances in degrees and feet between claim corners and to a public land survey monument are as depicted on the map.

4. If the claim is a placer or millsite claim with exterior limits conforming to legal subdivisions of the public survey, provide a legal description of the claim _____

AHC 440415

WHEN RECORDED MAIL TO:

Klump Ranches LLC
PO Box 448
Bowie AZ 85605

THE ABOVE SPACE RESERVED FOR RECORDING INFORMATION

CAPTION HEADING

DO NOT REMOVE

THIS IS PART OF THE OFFICIAL DOCUMENT

PHOENIX, ARIZONA

2016 DEC -2 P 3:47

RECEIVED
BLM AZ STATE OFFICE

AN0440416

Notice of Mining Location

LODE CLAIM

TO ALL WHOM IT MAY CONCERN:

This Mining Claim, the name of which is the Park #10

Mining Claim, situate on land belonging to the United States of America, and in which there are valuable mineral deposits, was entered upon and located for the purpose of exploration and purchase by

Klump Ranches LLC
PO Box 448 Bowie AZ 85605

(Locator must insert either "A Citizen of the United States," or "Who has declared his intention to become a Citizen of the United States.")
the undersigned, on the 29th day of November, 2016

The length of this claim is 1500 feet and 1 claim 100 feet in a easterly direction and 1400 feet in a westerly direction from the center of the discovery shaft, at which this notice is posted, lengthwise of the claim together with 300 feet in width of the surface grounds, on each side of the center of said claim. The general course of the lode deposit and premises is from the east to the west

The claim is situated and located in the Trevi's Mining District, in Cochise county, in the State of Arizona, about 3/4 Mile in a Das Cabezas Peaks direction from

RECEIVED
MINE STATE OFFICE
2016 DEC - 2 P 3:47
PHOENIX, ARIZONA

ANCH 410416

The surface boundaries of the claim are marked upon the ground as follows
Beginning at Monument of Stone

at a point in a easterly direction 100 feet from the discovery shaft (at which this notice is posted), being in the center of the easterly

end line of said claim; thence 300 feet to a Monument, being the NE corner of said claim;

thence 1500 feet to a Monument being at the NW corner of said claim; thence 300 feet

to a Monument at the center of the westerly end of this claim;

thence 300 feet to a Monument, being at the SW corner of said claim; thence 1500 feet

to a Monument at the SE corner of said claim; thence 300 feet to the place of beginning.

Dated and posted on the ground this 29th day of November, 2016

Klump Ranches LLC
MATT KLUMP

Witness

Locator(s)

Notice of Location

LODE CLAIM

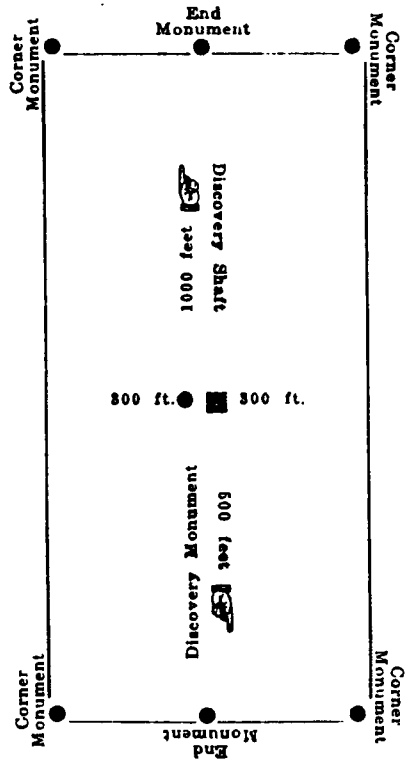

This diagram is to give locator a general idea of plan of location under the new law. The Discovery Shaft can be in the center of claim or any distance from either end desired. In the diagram it is placed 500 feet from one end, and 1000 feet from the other. Commence description of claim at a center end monument, giving its distance and direction from center of Discovery Shaft; thence bound the claim in either direction. In description be careful to state locality of claim with reference to some natural object, or permanent monument, as will identify the claim.

Dated _____, 19.....

STATE OF ARIZONA }
 County of } ss.

I hereby certify that the within instrument was filed and recorded at request of

Book.....

In Docket.....

on page.....

Witness my hand and official seal the day and year aforesaid.

.....
 County Recorder.

By.....
 Deputy Recorder.

PHOENIX, ARIZONA
 2016 DEC - 2 P 3:47
 RECEIVED
 PLM AT STATE OFFICE

MINING CLAIM MAP

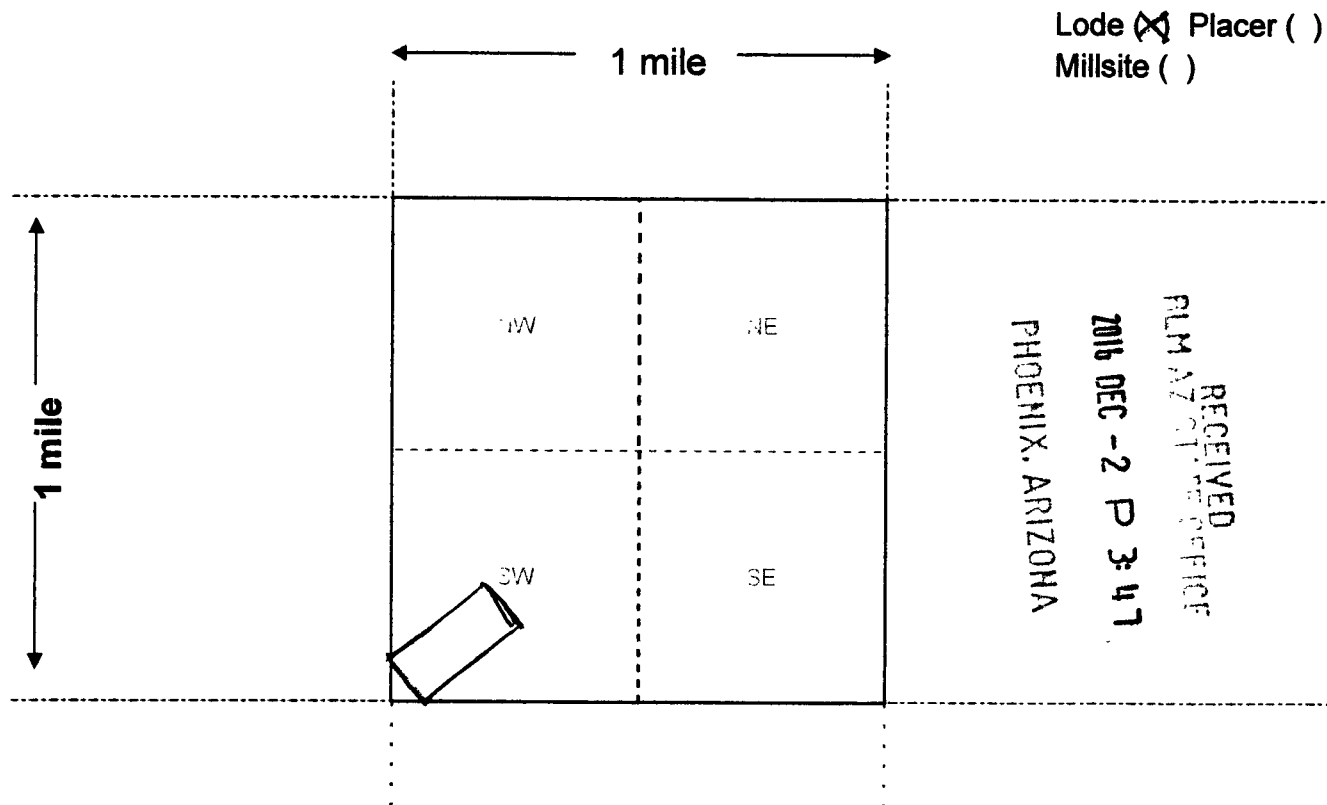

Scale: 1" = 2000 feet

1. The above map depicts the Park #10 mining claim, which is located in Section (s) 8, Township 14 S, Range 27 E, Gila and Salt River Base and Meridian, _____ County, Arizona. Total claim acreage is 20

2. The type of corner and location monuments used are as follows: MONUMENT OF STONE

3. The bearings and distances in degrees and feet between claim corners and to a public land survey monument are as depicted on the map.

4. If the claim is a placer or millsite claim with exterior limits conforming to legal subdivisions of the public survey, provide a legal description of the claim _____

AMC440416

DEPARTMENT OF INTERIOR
BUREAU OF LAND MANAGEMENT

Input Parameters for Geographic Report with Land

System Id = CR

Admin State = AZ

Geo State =

Casetype Begins With

Case Disp Txt = AUTHORIZED, CANCELLED, EXPIRED, PENDING, REJECTED, RELINQUISHED, WITHDRAWN

Mer Twp Rng =

Section =

Mtrs = 14 0140S 0270E 007, 14 0140S 0270E 008, 14 0140S 0270E 999

Commodity =

Commodity Txt =

Pending Org =

Pend Org Decode =

Total Rows Returned: 0

KlumpB... LLC
PO Box 118
Bowie AZ 85605

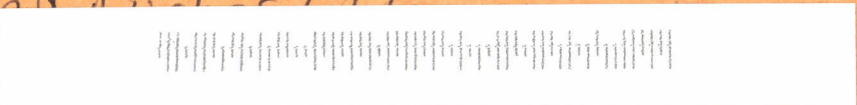

1000



85004

U.S. POSTAGE
PAID
WILLCOX, AZ
85643
NOV 30, 16
AMOUNT

\$1.99

R2304Y122721-09

BUREAU of LAND Management
ONE North Central Ave
Phoenix AZ 85004-2203

RECEIVED
BLM AZ STATE OFFICE
2016 DEC -2 P 3:23
PHOENIX, ARIZONA